



**snow peak**  
natural lifestyle creator since 1958



2011  
**SNOW PEAK**  
Natural Lifestyle Catalog





*Continuing the Legacy of Yukio Yamai*

Since 1958

CONTENTS	PAGE
1. New Products .....	06 - 13
2. Stoves .....	14 - 16
3. Lanterns .....	16 - 17
4. Cookware .....	18 - 23
5. Tableware / Cutlery.....	24 - 29
6. Furniture .....	30 - 33
7. Grills / IGT .....	34 - 38
8. Shelters .....	34 - 43

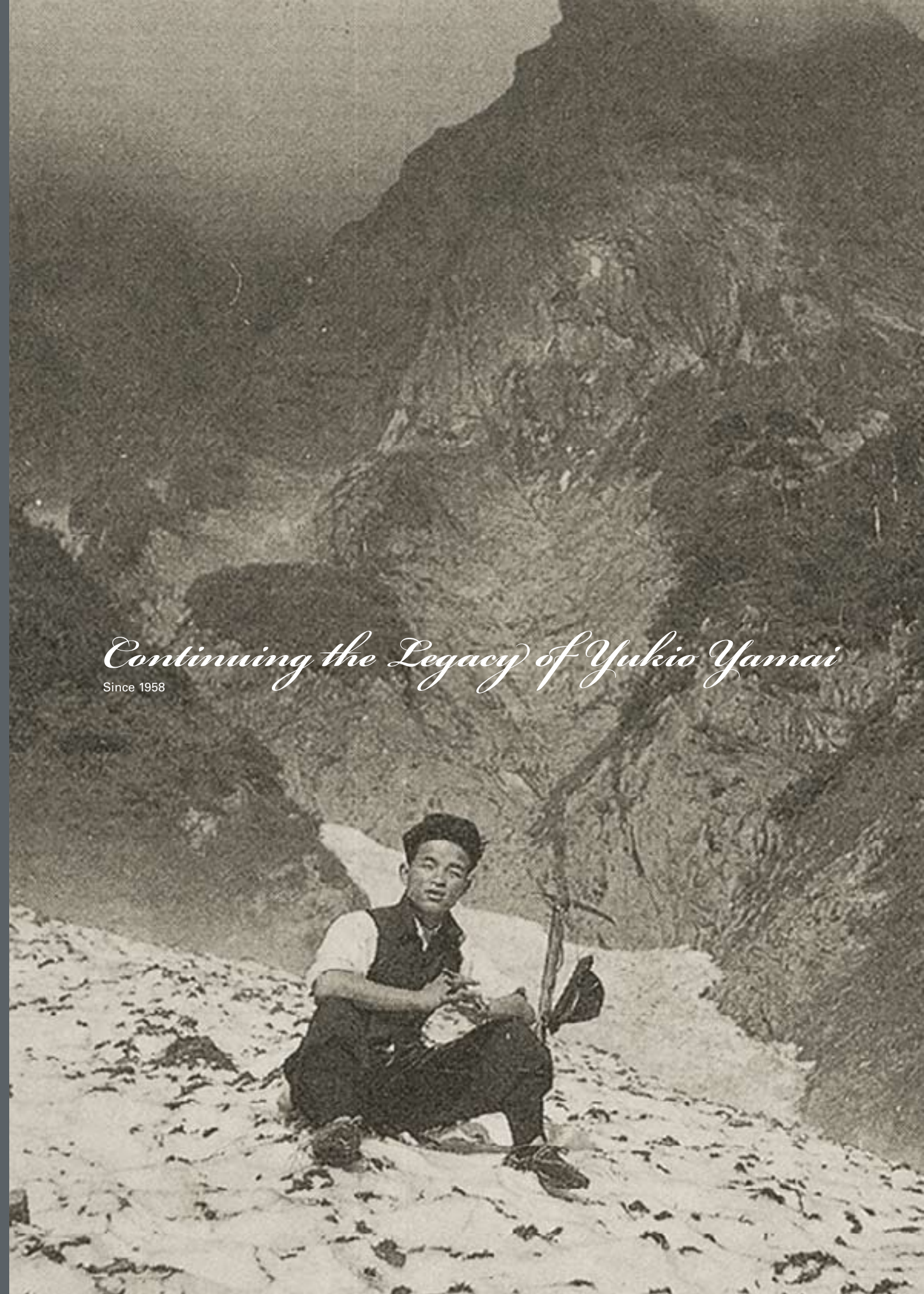





## WELCOME TO SNOW PEAK

Snow Peak's journey began in 1958, when our founder Yamai Yukio, an accomplished mountaineer, created his own line of superior gear out of dissatisfaction with available products. His innovative, pioneer spirit continues to guide our vision. Today, Snow Peak provides a wide range of high-quality outdoor products to discerning consumers worldwide. In 2011 we finished construction of a new Headquarters in the beautiful mountains of Sanjo City, where for generations to come we will continue to seek sanctuary in the 50 acres of wilderness.

Already becoming a place of pilgrimage for Snow Peak fans, the new headquarters is designed to merge the indoors and the outdoors as visitors are able to walk the halls and view the invention and manufacturing of Snow Peak products. A truly welcoming environment

which allows you to come and camp on the property with a minimal charge. We invite you and your family to come see us anytime.



# Snow Peak Headquarters

## MANUFACTURING

The manufacturing room is where many of the Snow Peak products are constructed. Keeping the process under one roof maximizes quality and efficiency.



## OFFICE

The office of Snow Peak is designed to eliminate unnecessary hierarchy. Everyone moves desks daily in an effort to improve community and the creativity of each member.



## ENVIRONMENT

The Headquarters is built to experience and preserve nature. The design merges the indoors and outdoors into one, and state of the art Green Technology ensures a minimal carbon footprint.



## SITE MAPE

There are 50 campsites available to the public on the grounds of Snow Peak. Future plans will be to expand that number to 200 individual camp sites for people to come and enjoy the beauty of nature.





# The Natural Lifestyle Creator

Part of Snow Peak's mission is that our ideas are always on the move, and we are to consistently innovate and build new trends. Our products are a clear evidence that we live out our mission as a company. In 2010 Snow Peak updated its logo's subtext to "Natural Lifestyle Creator," from our original "Outdoor Lifestyle Creator." This may seem like a subtle change, but for us this is a monumental movement on the part of our product design and emphasis. The more broad term, ironically is giving our company a more specific focus. That is to create products that are inspired by nature, and inspire the user to enjoy our natural world. In the coming years you will see Snow Peak innovate in both directions of more urban gear, yet also even more technical gear in some categories.

## A Mission of Excellence

We place our trust in the personal vision of each of our employees, and come together as a team unified by a common goal: to be the world's leading manufacturer of exceptional natural lifestyle products. We embrace our consumer's point of view as our own and deliver products and services that will inspire us both. Our ideas are always on the move. We constantly innovate and build new trends. We strive to create a positive impact through everything we do.

## To the Snow Peak Dealers

It is our greatest honor to work with the world's finest Retailers and Distributors. We wish to express our thankfulness and gratitude to you for your partnership with us in giving both a personal touch and professional service to all of Snow Peak's end-consumers. Thank you, and we look forward to another successful year!



# New Products



## SnowMiner Headlamp / Lantern

Snow Peak's new headlamp, the SnowMiner, offers a high quality headlamp that easily transforms into a hanging lantern. The backpacker can now light up the trail and the tent in a compact and lightweight solution. The SnowMiner's smart and patent pending design allows for the lens to be easily removed with a single hand, converting to an amazing ambient light spanning 180 degrees. The multi-function, sleek design, and long battery life are all included in this new product, the SnowMiner.



### Snow Miner Headlamp ES-020

**Brightness:** 60 Lumens (ANSI) on high

**Battery Life:** 140 hours on low, 55 hours on high, 3 X AAA batteries included (low battery indicator built-in)

**Water Resistance:** IPX4 classification

**Size:** Adjustable strap fits all / Headlamp Diameter: 56 mm, 53 mm wide

**Weight:** 2.9 oz (87g)

### Simple Transformations

By pushing on the sides of the silicone head you release the magnet on the lens, transforming the focused beam into an ambient light.

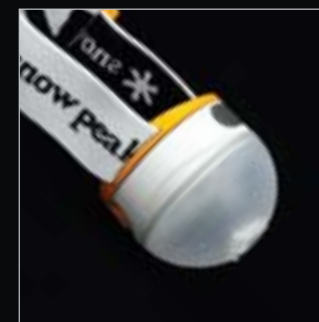
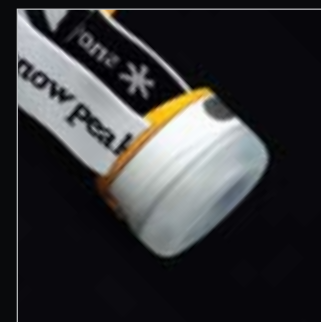

### Light Settings

Using the power button; the light features 3 different settings: High, Low, and Strobe. In addition, there is a low battery indicator built into the face of the headlamp.

### Hook Functions

Comfortable and stout. The hook nests within the headband and conforms to the contour of your head.

### Glove Friendly

All the joints, straps and buttons were designed to be functional even with the fat finger effect of wearing winter gloves.

### Tilt Function

Wide range of degrees from a rugged built-in hinge.





# Two-Unit IGT

The Two-Unit Iron Grill Table is available in a BBQ or single burner stove configuration giving you the freedom to cook up your favorite food anywhere you want. The ultra portable Two-Unit IGT can fit into any car and can be simply set up in a couple minutes. With all the various add-on IGT components you can upgrade and customize your grill to however you want it to be. Picnic in style with all the ease and comfort of this beautifully designed table.



## Two-Unit Barbecue Set CK-170SET-1

**Material:** Stainless steel Legs and Frame with plastic adjustable feet, stainless steel Barbecue Box

### Set Includes

- Two-Unit Frame and case
- 660 Legs (sitting height)
- Barbecue Box
- 2 Stainless Steel Inserts



## Two-Unit Single Burner Set CK-170SET-2

**Material:** Stainless steel Legs and Frame with plastic adjustable feet, stainless steel Baja Single Burner stove

### Set Includes

- Two-Unit Frame and case
- 660 Legs (sitting height)
- Baja Single Burner
- 2 Stainless Steel Inserts



## Delux Carrying Case CK-091BR

**Material:** Canvas #6  
**Size:** Designed to fit; Two-Unit IGT, Legs, Stainless Steel Inserts, Baja Burner and other accessories

## Lite Carrying Case CK-090BR

Not Shown

## Customizing your table

Refer to page 40 to see more inserts and options for this table. With the many extensions and inserts available, your imagination is your only limiting.

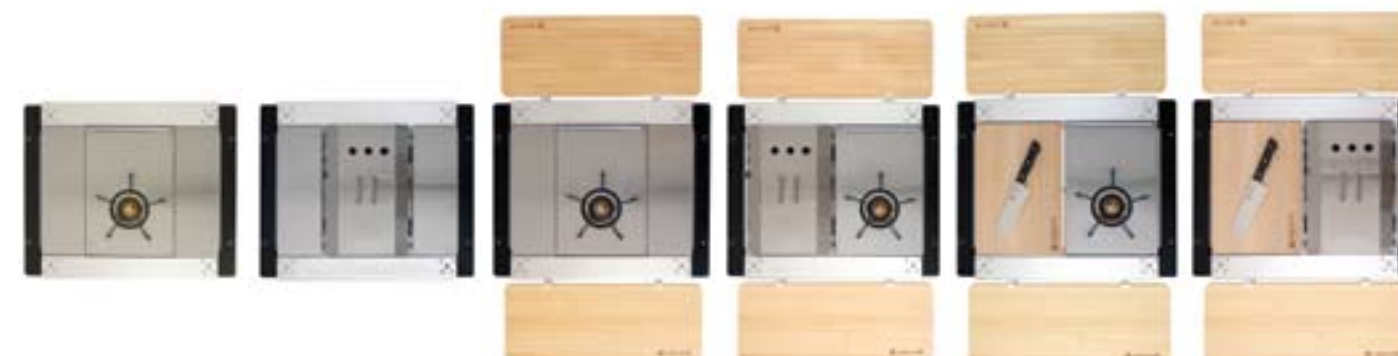

# Tulip Lantern

Inspired by the natural shape of the Tulip flower we have developed a cutting edge outdoor light. The Tulip is an ultra bright, 250 Lumens lantern that can illuminate a wide and a focused area. Using the force of gravity, the light will spread wide when pointed up and focus to a spot light when pointed down. Whether it's sitting on a table top or hanging from it's built-in hook, the flexible stem can be positioned to suit any situation.



## Tabletop or Hanging

The lamp stem can be easily adjusted to focus light wherever you need it. A built-in hook can be used to hang your light anywhere you need.

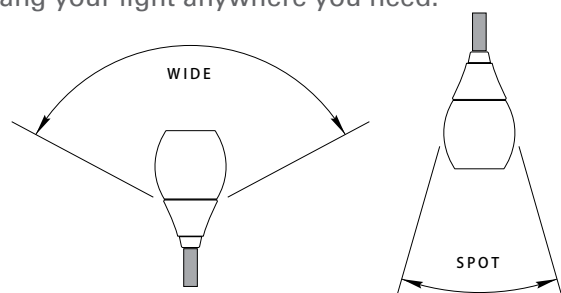

## Auto Transformation

While standing upright the lantern light will create a wide ambient light. Simply tip the lantern upside-down or point the light down to allow the light to create a bright spot light.

## Tulip Lantern ES-030

**Material:** Polycarbonate, plastic abs (Box Cell) Silidone rubber, stainless steel, aluminum  
**Size:** 4.3inx15.4in (excluding hanging loop)  
**Weight:** 17.6 oz (without batteries)  
**Brightness:** 250 Lumens  
**Battery Life:** Hi = 10 hours, Mid = 25 hours, Low = 100 hours

**Height:** 15.4 inch  
 The flexible stem makes it easy to focus the light in any direction.

Hi : 10h  
 Mid : 25h  
 Low : 100h

## Long Lasting, High Intensity

At maximum intensity the batteries will last 10 hours. Economy setting will extend the batteries 100 hours.



Uses 3X D Alkaline batteries or Ni-MH



# Hybrid Spatula

The Hybrid Spatula is the perfect solution for the gourmet cooking backpacker. This lightweight and one-of-kind design takes the spatula used in the ever-day kitchen, and transforms it to fit the needs of the backpacker. Not only is this a superior spatula, but the handle was made with a hollow core to allow the Snow Peak titanium spork to fit within it with the purpose of extending your spork handle. If your first few days on the trail are filled with gourmet cooking with your fresh foods, then when you are stuck with freeze dried meals on day three, extend out the spork handle with the removable spatula handle for a clean-hand eating experience.



## Hybrid Spatula SCT-200

**Weight:** Handle = 0.25 oz / Head = 0.75 oz  
**Dimensions:** 6 3/4 Long X 2 3/16  
**Material:** Spatula Head = FDA Food Grade Silicon, Handle = Nylon

## Features

Silicone is resilient up to 400 °F, allowing you to safely cook under very high temperatures. The sharp and flat edge is perfect for flipping as well as for scraping every last morsel of food out of your pot or pan.

## Transformation

With a minimal amount of material and weight, transform your spork into a multi functional cooking tool by simply slipping on the Nylon sleeve and attaching the spatual head.





# Solo Table

The Solo Table features a smart design that allows for maximum strength, simple set-up, and extremely useful features. The 100 percent aluminum body allows for a lightweight and corrosion proof table that may be used to keep your food out of the snow, sand, or dirt. It packs up into a simple and lightweight package. The fabric case may be secured to the legs therefore doubling its usage as a stabilizer in both snow and sand, where normal tables simply sink. The Solo Table is the ultimate balance in strength, weight, and function.



## Solo Table SLV-170

**Material:** Aluminum  
**Size:** 4 X 16 X 12 inches  
**Includes Case**

### Compact

Easily disassemble and stow in a compact case.



### Functional Design

The size is a perfect balance for the backpacking minimalist's needs.



### Strength

Built to withstand weight well beyond the potential needs of the backpacker.



# Accessories



Black



Red



Blue

## Tokyo Transit Wallet MB-140

**Material:** Nylon  
**Size:** 3 1/4 X 4 inches  
**Colors:** Black, red, Blue



Black

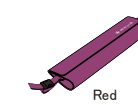

Red

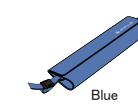

Blue

## Foldout Map Case MB-135

**Material:** Nylon  
**Size:** 8 X 4 inches  
**Colors:** Black, red, Blue

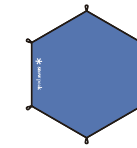
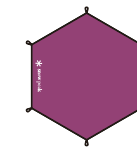
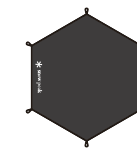
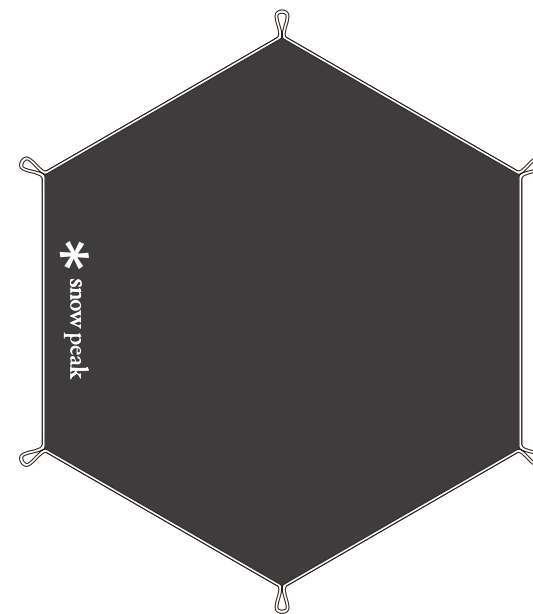

## Community Sheet MB-145

**Material:** Nylon  
**Size:** 6 foot diameter  
**Colors:** Black, red, Blue





# Stoves and Lighting

GigaPower Stove series, Lanterns, and Accessories.



## LiteMax GST-120

**Weight:** 1.9 oz  
**Dimensions:** 5 1/2 X 5 X 4 5/8 inches  
**Material:** Titanium, Stainless steel, Brass  
**Output:** 11,200 BTU's



boiling time ⌚ **4:25min**  
/1 liter

## LI Metal Crab Stove GS-320

**Weight:** 10.4 oz  
**Dimensions:** 5 1/2 X 5 X 4 5/8 inches  
**Material:** Stainless steel, Brass  
**Output:** 10,000 BTU's



boiling time ⌚ **5:17min**  
/1 liter

## GigaPower Stove, Auto GS-100A

**Weight:** 3.75 oz  
**Material:** Stainless steel, Aluminum, Brass  
**Output:** 10,000 BTU's

## GigaPower Stove, Manual GS-100

**Weight:** 3.0 oz



boiling time ⌚ **4:48min**  
/1 liter

## Windscreen GP-0008

**Weight:** 2.0 oz  
**Dimensions:** 4 4/8 X 5/8 inches  
**Material:** Stainless steel



## Double Burner Stove GS-220

**Weight:** 15.5 lbs  
**Dimensions:** 19 3/4 X 14 X 4 1/4 inches  
**Material:** Stainless steel, Brass, Aluminum  
**Output:** 11,200 BTU's



boiling time ⌚ **4:43min**  
/1 liter

## Camping Li Stove GS-1000

**Weight:** 4 lbs  
**Dimensions:** 13 3/4 X 10 5/8 X 15 1/2 inches  
**Material:** Stainless steel, Brass, Aluminum  
**Output:** 34,000 BTU's



boiling time ⌚ **2:30min**  
/1 liter



**Baja Single Burner Stove** GS-320

**Weight:** 10.4 oz  
**Dimensions:** 9 7/8 X 14 X 5 1/2 inches  
**Material:** Stainless steel, Brass  
**Output:** 12,000 BTU's



Also designed to fit inside the Iron Grill Table for a very sleek and clean look. (Refer to page XXX)

**GigaPower Touch** GT-100

**Weight:** 6.2 oz  
**Dimensions:** 7 1/4 X 11 1/2 X 5 1/2 inches  
**Material:** Stainless steel, brass, nylon  
**Output:** 14,000 BTU's



**GigaPower Stove Maintenance Kit** GPP-019



**GigaPower Lantern Maintenance Kit** GPP-035



**GigaPower Lantern, Auto** GL-100A

**Weight:** 4.5 oz  
**Dimensions:** 2 1/4 d X 3 3/4 inches  
**Material:** Stainless Steel, Aluminum, Brass, Heat-resistant glass  
**Output:** 80 Watts



**GigaPower Gas ProIso / Iso**

The Snow Peak GigaPower Fuel mixture is the designed to maximize efficient real life usage. We use a mix of 15% Propane and 85% IsoButane (with a 5% variance). The result is a low temperature usage of 15 Degrees Fahrenheit and allows us to maximize our fuel volume within the canister. Snow Peak's fuel continues to be one of the top selling and most trusted choices in the marketplace.



**GP-500G**  
**Weight:** 460 g  
**Material:** Propane, Iso-Butane mix



**GP-250G**  
**Weight:** 220 g  
**Material:** Propane, Iso-Butane mix



**GP-110G**  
**Weight:** 110 g  
**Material:** Propane, Iso-Butane mix

**Hozuki Lantern**

The sacred Hozuki plant was the original design for the ancient Chinese paper lantern. We have adapted this design to capture the beauty and romance of this naturally found lantern in the creation of this new Snow Peak product. The new Hozuki Lantern combines functionality and beauty like never before in outdoor lighting. Now, you can create the romance of a candle without burning down your tent. The Hozuki Lantern features an innovative Candle Mode that allows the LED to respond to sound or wind with a realistic flicker of light.



**Flicker Mode**

Starting in OFF mode, double click the power button to enable "Flicker Mode" and the Hozuki Lantern will now respond the wind to create the sense of a flickering candle

**Low Battery Indicator**

An orange LED softly blinks indicating when batteries are too low to properly work.



- 4 X AA
- Water Resistant casing
- 80 Hours on lowest setting

**Hook Function**

The hook handle can also be used as a table-top stand by stabilizing the top sphere of the lantern.



- USB Power
- Table Stand
- Removable

**Product Specifications**

**Weight:** 5.9 oz  
**Material:** Polycarbonate plastic, ABS resin, acrylic resin, silicone rubber, aluminum  
**Dimension:** 4 in X 4 in X 9.8 in (when hung)  
**Water Resistance:** IPX4 classification

**Brightness:** 100 Lumens (ANSI) on High  
**Power Source:** 4 x AA rechargeable alkaline batteries or USB Mini Plug-in  
**Lighting Hours:** High 8 hrs / Mid 20 hrs / Low 80 hrs



# Cookware

Cutlery, Kitchen Tools, Cookware, Cooking Kits & Drinkware



## HotLips Titanium Mug MGH-004

System Weight: 7.9 oz



### HotLips

**Material:** Silicone  
**Weight:** 0.3 oz  
**Heat Resistance:** -40°F – 446°F  
 \*microwave, dishwasher and freezer safe

### Titanium 600 Mug

**Material:** Titanium  
**Capacity:** 600ml or 21.2 fl oz  
**Weight:** 2.9 oz w/ hotlips

#### Stacking System

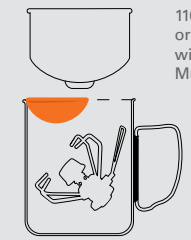

110 Fuel and a GigaPower™ or LiteMax™ Stove will fit perfectly inside the Mug.



Keep your liquids hot and your lips safe. Add a HotLips™ to any 600 size Mug for a protective barrier between the scolding hot metal mug and your mouth.



## HotLips 2 piece set MGH-001

**Material:** Silicone  
**Weight:** 0.3 oz Each  
**Heat Resistance:** -40°F – 446°F  
 \*microwave, dishwasher and freezer safe

## Hybrid Trail Cookset STW-004T

System Weight: 7.9 oz



### Silicone Bowl

**Material:** Silicone  
**Weight:** 2.7 oz  
**Capacity:** 12 fl oz  
**Temperature Range:** -40°F to 446°F  
 \*microwave, dishwasher and freezer safe

### Mini Spork

**Material:** Titanium  
**Weight:** 0.5 oz

### Titanium Pot & Pan

**Material:** Titanium  
**Weight:** Pot = 2.5 oz, Pan = 2.2 oz  
**Capacity:** Pot = 26 fl oz, Pan = 14 fl oz

#### Stacking System

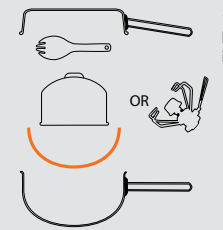

110 Fuel or a GigaPower™ Stove will stow inside this set.



1. Mold the outer walls to form a drinking bowl. 2. Squeeze two sides together to create a pouring spout. 3. To clean, simply turn the bowl inside-out and wipe clean with a towel or tongue.

## Hybrid Summit Cookset SCS-004TH

System Weight: 6.1 oz



### Titanium Mini Solo Pot

**Material:** Titanium  
**Capacity:** 28 fl oz  
**Weight:** 3.0 oz

### Silicone Cup & Lid

**Material:** Silicone  
**Weight:** Cup = 1.2 oz Lid = 1.8 oz  
**Capacity:** Cup = 10 fl oz  
**Temperature Range:** -40°F to 446°F  
 \*microwave, dishwasher and freezer safe

#### Stacking System

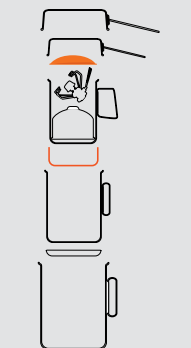

Trek 1400 pan (p.29)  
 Trek 900 pan (p.29)  
 Silicone lid  
 Fuel + GigaPower™ / LiteMax™ stove  
 Silicone cup  
 Trek 900 pot  
 Windscreen (p.16)  
 Trek 1400 pot (p.29)



The perfect marriage of materials; titanium and silicone, create a stylish and versatile cookset. Silicone can safely withstand temperatures up to 446°F. Use the cup as a sleeve to hold the warm pot.



# Trek Cookware Series

The Trek Series is designed to be a building block for lightweight and compact outdoor cooking. Start at any size, then build up or down depending on your needs. Since all of the Trek Cooksets are available in Titanium, you won't even notice the weight difference whether cooking for 2 or 6 people.

## Trek 700 Cooker

Small Pot & Lid

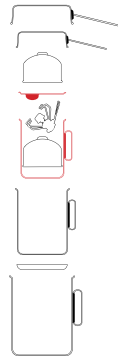

### Trek 700, Titanium SCS-005TR

**Weight:** 4.8 oz  
**Material:** Titanium  
**Capacity:** 24 fl oz  
**Dimensions:** Ø4 1/8 X 4 3/8 inches

Lighter and more functional, the silicone lid is created to increase boiling time and a HotLips protector for drinking.

## Trek 900 Cooker

Medium Pot & Pan/Lid

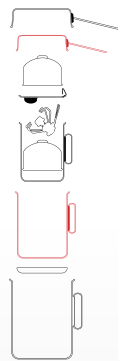

### Trek 900, Titanium SCS-008T

**Weight:** 6.2 oz  
**Material:** Titanium  
**Capacity:** Pot: 30 fl oz, Lid: 8 fl oz  
**Dimensions:** Ø4 3/4 X 4 1/4 inches

### Trek 900, Aluminum SCS-008

**Weight:** 9.3 oz  
**Material:** Aluminum with Alumite protective coating  
**Capacity:** Pot: 30 fl oz Lid: 8 fl oz  
**Dimensions:** Ø4 3/4 X 4 1/4 inches

## Trek 1400 Cooker

Large Pot & Pan/Lid



### Trek 1400, Titanium SCS-009T

**Weight:** 7.4 oz  
**Material:** Titanium  
**Capacity:** Pot: 47 fl oz / Lid: 17 fl oz  
**Dimensions:** Ø5 3/4 X 5 7/8 inches

### Trek 1400, Aluminum SCS-009

**Weight:** 10.8 oz  
**Material:** Aluminum with Alumite protective coating  
**Capacity:** Pot: 47 fl oz / Lid: 17 fl oz  
**Dimensions:** Ø5 3/4 X 5 7/8 inches

## Trek Combo Cookset

Double Pot & Pan/Lid Set



### Trek Combo, Titanium SCS-010T

**Weight:** 13 oz  
**Material:** Titanium  
**Capacity:** Pot1: 47 floz, Lid1: 17 floz / Pot2: 30 floz, Lid2: 8 floz  
**Dimensions:** L pot: Ø5 3/4 X 5 7/8 inches  
 S pot: Ø5 3/4 X 5 7/8 inches

### Trek Combo, Aluminum SCS-010

**Weight:** 19.6 oz  
**Material:** Aluminum with Alumite protective coating  
**Capacity:** Pot1: 47 floz, Lid1: 17 floz / Pot2: 30 floz, Lid2: 8 floz  
**Dimensions:** Ø5 3/4 X 5 7/8 inches

## Mini Solo Cookset, Ti

**Weight:** 5.5 oz  
**Material:** Titanium  
**Capacity:** Pot= 28 fl oz, Cup= 10 fl oz  
**Dimensions:** Ø4 1/4 X 5 1/8 inches

## Mini Solo Cookset

**Weight:** 8.75 oz  
**Material:** Non-stick coated Aluminum  
**Capacity:** Pot= 28 fl oz, Cup= 10 fl oz  
**Dimensions:** Ø4 1/4 X 5 1/8 inches

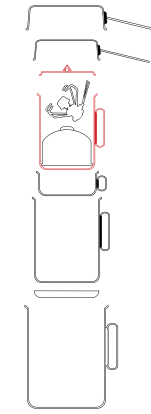

## 3 Piece Cookset, Ti STW-001T

**Weight:** 7.1 lbs  
**Material:** Titanium  
**Capacity:** Pot1= 26 fl oz, Pot2= 18 fl oz, Pan= 14 floz  
**Dimensions:** Pot1= Ø5 1/2 X 2 1/4, Pot2= Ø5 X 2 1/8 inches



## Kettle Cooker No.1 CS-068

**Weight:** 9.0 oz  
**Material:** Stainless steel  
**Capacity:** 30 fl oz  
**Dimensions:** Ø5 X 3 1/2 inches



## Multi-Compact Cookset, Ti SCS-020T

(also available in aluminum)

**Weight:** 11.6 oz  
**Material:** Titanium  
**Capacity:** Pot1= 32 fl oz, Pan1= 14 fl oz, Pot2= 23 fl oz, Pan= 10 floz  
**Dimensions:** Pot1= Ø5 7/8 X 2 7/8, Pot2= Ø5 X 2 3/4 inches



## Cook&Save SCS-011T

**Weight:** 8 oz  
**Material:** Titanium  
**Capacity:** 67.6 fl oz  
**Dimensions:** Ø6 5/8 X 4 inches



## Starter Kit SCS-011TR

**Weight:** Pot = 4.8 oz, Spork = 0.6 oz, Stove = 3.75 oz  
**Material:** Pot / Spork = Titanium, Stove = Stainless Steel, Aluminum and Brass  
**Pot Capacity:** 24 fl oz  
 \* Fuel sold separately





**Micro Pot CS-501**

**Weight:** 3.08 lbs  
**Dimensions:** 5 1/8 X 5 1/8 inches  
**Material:** Cast Iron



**Cast Iron Duo Cookset CS-550**

**Weight:** 8.6 lbs  
**Includes:** Large pans, large pot, 2 small pans, 2 detachable pan-handles, lid and carrying bag  
**Material:** Cast Iron, canvas bag



**Japanese Iron Oven 30 CS-530**

**Weight:** 20.72 lbs  
**Material:** Cast Iron  
**Capacity:** Pot= 284 fl oz, Pan= 132 fl oz  
**Dimensions:** Ø12 inches

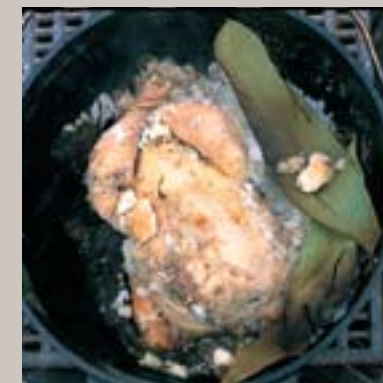

**Micro Oval CS-503**

**Weight:** 5.73 lbs  
**Dimensions:** 6 2/8 X 8 1/4 inches  
**Material:** Cast Iron



**Cast Iron Box Oven GR-016**

**Weight:** 4.85 lbs  
**Includes:** lid/griddle, rectangle casserole pot, and stainless steel grill net  
**Dimensions:** 14 1/8 X 8 5/8 inches  
**Material:** Cast Iron



**Japanese Iron Oven 26 CS-520**

**Weight:** 16.75 lbs  
**Material:** Cast Iron  
**Capacity:** Pot= 182 fl oz, Pan= 87 fl oz  
**Dimensions:** Ø10.5 inches



**Micro Capsule CS-502**

**Weight:** 4.18 lbs  
**Dimensions:** 3 1/2 X 11 1/8 X 3 1/2 inches  
**Material:** Cast Iron



**Box Oven Multi Purpose Bag UG-078**

**Weight:** 28 oz  
**Dimensions:** 14 1/8 X 8 5/8 inches  
**Material:** Canvas



**Japanese Iron Oven 22 CS-510**

**Weight:** 10.58 lbs  
**Material:** Cast Iron  
**Capacity:** Pot= 108 fl oz, Pan= 54 fl oz  
**Dimensions:** Ø8.9 inches





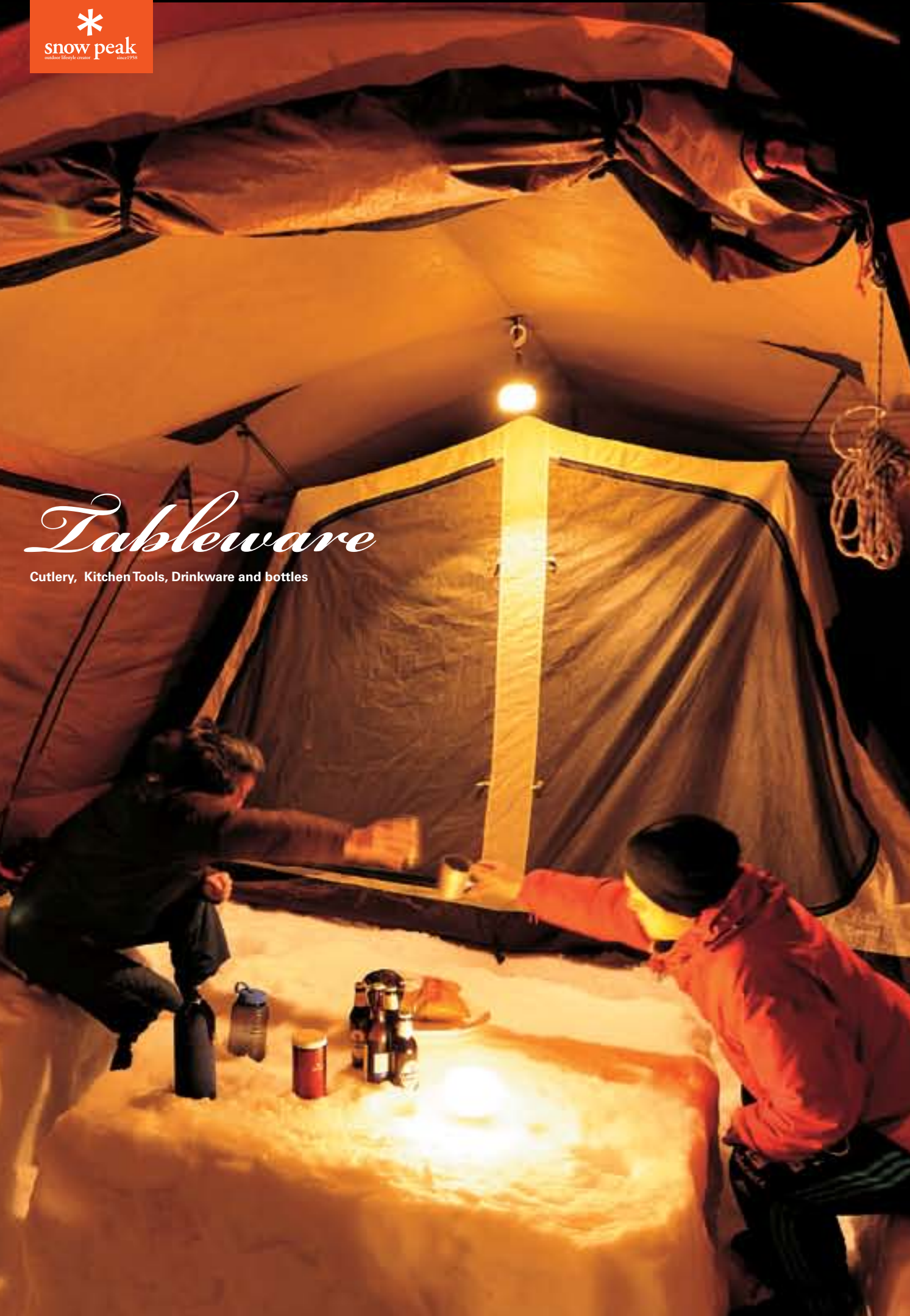

# Tableware

Cutlery, Kitchen Tools, Drinkware and bottles

## Carry-on Chopsticks

In 1996, a portable, collapsible chopstick was born in Japan on the concept that “we do use disposable cutlery!” The concept was widely accepted and every year since then has only increased in popularity. In 2009, the second generation of “Carry-on Chopsticks” was born, which improved upon the design by adding traditional “his and hers” sizes, squaring off the handle to prevent them from rolling off the table, adding bamboo to the tips, and improving the function of the brass fitting.

**Carry-on Chopsticks** SCT-103  
(The Original)



### Function

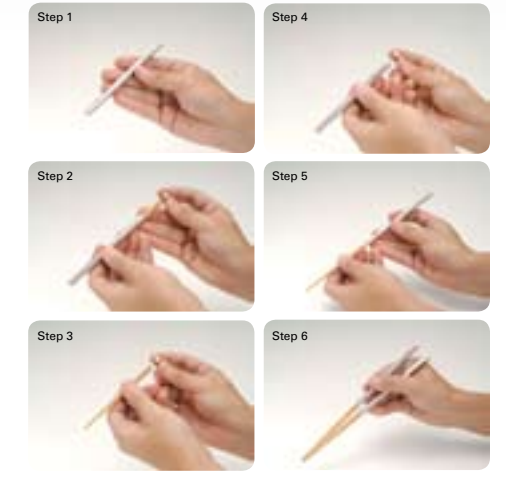

**Carry-on Chopsticks** SCT-103  
Weight: 1.4 oz  
Length: 8 1/2 inches  
Material: Recycled White Ash, Stainless Steel

**Collapsible Chopsticks (M)** SCT-110  
Weight: 1.6 oz  
Length: 8 1/8 inches  
Material: Stainless Steel, Aluminum, Brass, Bamboo

**Collapsible Chopsticks (L)** SCT-111  
Weight: 1.8 oz  
Length: 8 7/8 inches  
Material: Stainless Steel, Aluminum, Brass, Bamboo





# 450 Colored Mugs

## Colored Sporks SCT-004 BL, GR, PR

Weight: 0.6 oz  
 Dimensions: 6 1/2 X 1 5/8 inches  
 Material: Titanium



## Chopping Board Knife Set L CS-208

Weight: 30.4 oz  
 Dimensions: 14 1/8 X 9 1/4 in. Blade Length: 6 1/2 in.  
 Material: Stainless steel knife, Solid Wood Case / Cutting board



## Chopping Board Knife Set M CS-207

Weight: 16.6 oz  
 Dimensions: 10 1/8 X 8 inch, Blade Length: 4 3/4  
 Material: Stainless steel knife, Solid Wood Case / Cutting board



## 450 Double Wall MG-053(BL, GR, PR)

Weight: 4.2 oz  
 Material: Titanium  
 Capacity: 14 fl oz



## 450 Single Wall MG-043(BL, GR, PR)

Weight: 2.4 oz  
 Material: Titanium  
 Capacity: 14 fl oz



## Spork SCT-004

Weight: 0.6 oz  
 Dimensions: 6 1/2 X 1 5/8 inches  
 Material: Titanium



## Short Spork SCT-006

Weight: 0.5 oz  
 Dimensions: 4 5/8 X 1 5/8 inches  
 Material: Titanium



## Titanium Plate STW-003T

Weight: 2.0 oz  
 Material: Titanium  
 Dimensions: 7.5 inch diameter



## Ti Fork & Spoon SCT-002

Weight: 1.8 oz  
 Material: Titanium  
 Dimensions: 6 1/2 X 1 5/8 inches



## Ti Fork, Spoon & Knife SCT-001

Weight: 1.4 oz  
 Material: Titanium  
 Dimensions: 6 1/2 X 1 5/8 inches

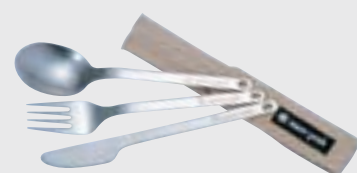

## Titanium Bowl STW-002T

Weight: 1.6 oz  
 Material: Titanium  
 Dimensions: 5.5 inch diameter



## Double Wall Cup 220 MG-051FH

Weight: 3 oz  
 Material: Titanium  
 Capacity: 10.6 fl oz



## Double Wall Cup 300 MG-052FH

Weight: 3 oz  
 Material: Titanium  
 Capacity: 10.6 fl oz



## Double Wall Cup 450 MG-053

Weight: 4.2 oz  
 Material: Titanium  
 Capacity: 14 fl oz



## Double Wall Cup 600 MG-054

Weight: 5.1 oz  
 Material: Titanium  
 Capacity: 20 fl oz



## Single Wall Cup 220 MG-041FH

Weight: 2 oz  
 Material: Titanium  
 Capacity: 10.6 fl oz



## Single Wall Cup 300 MG-042FH

Weight: 2 oz  
 Material: Titanium  
 Capacity: 10.6 fl oz



## Single Wall Cup 450 MG-043

Weight: 2.4 oz  
 Material: Titanium  
 Capacity: 14 fl oz



## Single Wall Cup 600 MG-044

Weight: 2.8 oz  
 Material: Titanium  
 Capacity: 21.2 fl oz



## Thermal Lids MGC-052, MGC-053

Available for the 300-Mug and 450-Mug  
 Weight: 0.9 oz and 1.1 oz



## Titanium Single Cup 2 MG-002

Weight: 1.3 oz  
 Material: Titanium  
 Capacity: 8 fl oz





**Stainless Steel Cup E-010**

**Weight:** 3.3 oz  
**Material:** Stainless Steel  
**Capacity:** 10.6 fl oz



**Double Wall 240 Mug MG-112**

**Weight:** 7.6 oz  
**Material:** Stainless Steel  
**Capacity:** 8.1 fl oz



**Double Wall 330 Mug MG-113**

**Weight:** 8.1 oz  
**Material:** Stainless Steel  
**Capacity:** 10 fl oz



**Backpackers Cup E-104**

**Weight:** 3.8 oz  
**Material:** Stainless Steel  
**Capacity:** 10.9 fl oz



**Backpackers Titanium Cup E-103**

**Weight:** 1.4 oz  
**Material:** Titanium  
**Capacity:** 10.9 fl oz



**Round Titanium Flask T-015**

**Weight:** 2.1 oz  
**Material:** Titanium  
**Capacity:** 6.7 fl oz



**Large Titanium Flask T-013**

**Weight:** 2.7 oz  
**Material:** Titanium  
**Capacity:** 6 fl oz



**Medium Titanium Flask T-012**

**Weight:** 2.3 oz  
**Material:** Titanium  
**Capacity:** 5 fl oz



**Small Titanium Flask**

**Weight:** 1.9 oz  
**Material:** Titanium  
**Capacity:** 3.7 fl oz



**Café Latte Press Set CS-111**

**Weight:** 6.3 oz  
**Material:** Titanium



**Café Press CS-111**

**Weight:** 6.3 oz  
**Material:** Titanium  
**Dimensions:** 24 fl oz



**Coffee Drip CS-113**

**Weight:** 4.9 oz  
**Material:** Stainless Steel



**Titanium Kanpai Bottle TW-180**

**Capacity:** 13 fl oz (can fit a 12 oz aluminum can)  
**Weight:** 10 oz  
**Material:** 18-8 Stainless Steel



**Kanpai 350 TW-070(PW, WR, DS)**

**Capacity:** 13 fl oz (can fit a 12 oz aluminum can)  
**Weight:** 10 oz  
**Material:** 18-8 Stainless Steel



**Kanpai 500 TW-071(PW, WR, DS)**

**Capacity:** 18 fl oz (can fit a 16 oz aluminum can)  
**Weight:** 12.5 oz  
**Material:** 18-8 Stainless Steel



These included lids all serve their own distinguished function. Enjoy your beverage they way you like.



**Tumbler Lid**

Use this lid to drink directly from the bottle. The built-in sliding cover prevents liquids from splashing.



**Cooler Lid**

The gel inside this lid keeps your liquids cold for up to 6 hours. Toss it in the freezer and enjoy a cold beverage.



**Thermal Lid**

Use this insulated lid for hot liquids and never worry about spilling.







# Outdoor Furniture

Tables, Chairs, Pack&Carry fire place & Iron Grill Table

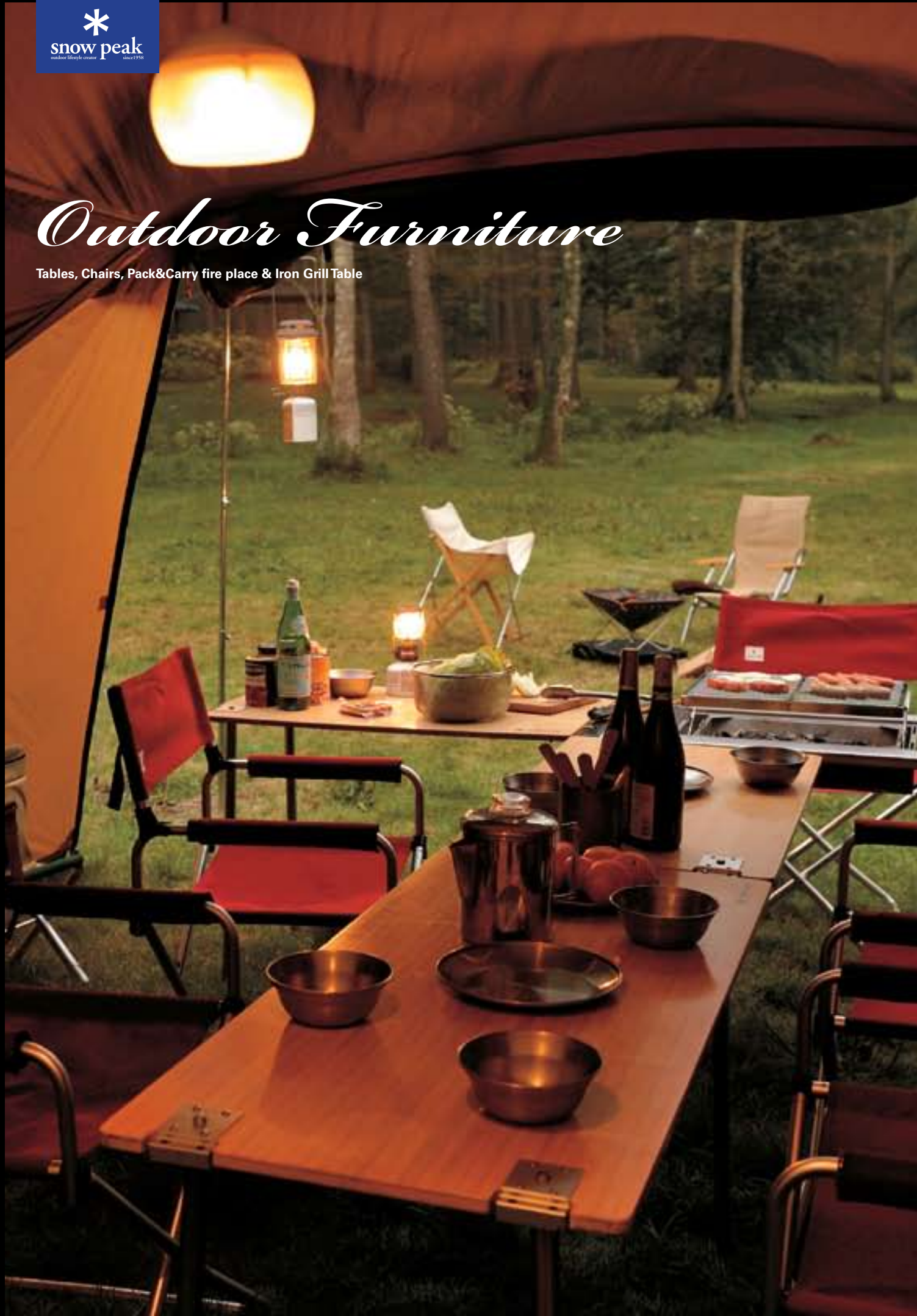

## Outdoor Tables

### Single Action Table LV-010T

Weight: 22 lbs  
 Dimensions: 28 X 36 X 26 inches  
 Material: Bamboo top, Aluminum legs



### Sing Action Table (long) LV-015T

Weight: 28 lbs  
 Dimensions: 28 X 48 X 28 inches  
 Material: Bamboo top, Aluminum legs



### Single Action Low Table LV-100T

Weight: 16 lbs  
 Dimensions: L 33 1/2 X W 19 1/2 X H 16 inches  
 Material: Bamboo top, Aluminum legs, stainless steel, and polyester bag



### My Table LV-034T

Weight: 4 lbs  
 Dimensions: 18 X 13 1/4 X 16 inches  
 Material: Bamboo top, Aluminum legs



### Single Action Low Table (Large) LV-071T

Weight: 8.4 lbs  
 Dimensions: 25 5/8 X 8 1/8 inches  
 Material: Bamboo top, Aluminum legs



### Single Action Low Table (Small) LV-070T

Weight: 4.6 lbs  
 Dimensions: 19 3/4 X 7 1/8 inches  
 Material: Bamboo top, Aluminum legs





# Outdoor Chairs

## Take! Bamboo Chair LV-080

**Weight:** 6.6 lbs  
**Dimensions:** 21 5/8 X 24 3/4 X 29 1/2 inches  
**Material:** Bamboo, Canvas



## Take! Bamboo Chair (long) LV-081

**Weight:** 7.7 lbs  
**Dimensions:** 23 X 31 X 39 inches  
**Material:** Bamboo, Aluminum, Stainless steel, Canvas



## Low Beach Chair LV-090

**Material:** Bamboo handles, Aluminum, Canvas, Stainless Steel  
**Colors:** Khaki, Orange, Yellow, Green, Turquoise



## Black Directors Chair LV-070G-BK

**Weight:** 6.8 lbs  
**Dimensions:** 22 1/2 X 22 X 33 inches  
**Material:** Nylon hyperon, Neoprene, Nylon cover



## Folding Chair LV-070RD

**Weight:** 7.7 lbs  
**Dimensions:** 22 1/2 X 22 X 33 inches  
**Material:** Aluminum, Zinc Die-cast joints, Polyester Canvas

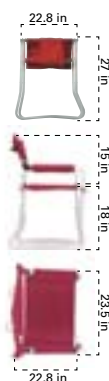

## New Colors



## Pad in Chair (Green) LV-055PG

**Weight:** 6.8 lbs  
**Dimensions:** 22 1/2 X 22 X 33 inches  
**Material:** Nylon hyperon, Neoprene, Nylon cover



## Pad in Chair (Red) LV-055RR

**Weight:** 6.8 lbs  
**Dimensions:** 22 1/2 X 22 X 33 inches  
**Material:** Nylon hyperon, Neoprene, Nylon cover



## Compact Panel Chair SLV-010

**Weight:** 3.7 lbs  
**Material:** 600D Polyester, Fiber-glass



## Baja Table SLV-001

**Weight:** 31 oz  
**Dimensions:** 4 X 16 X 12 inches  
**Material:** Aluminum

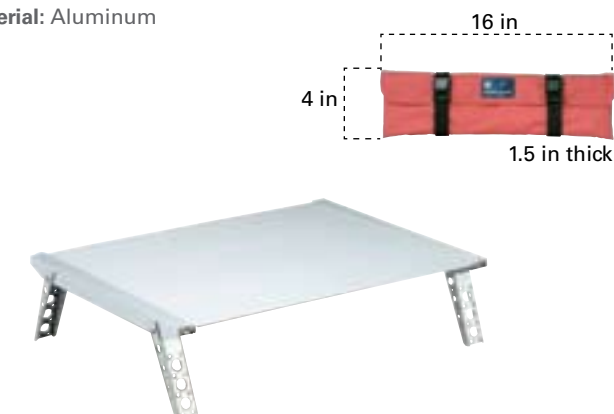





# Outdoor Grills

Iron Grill Table, Barbeques & Fire Place



# Iron Grill Table

The Iron Grill Table, or better translated "World's Greatest Grill Table," is one of our flagship products. The Iron Grill Table integrates many of our stoves, grills, cutting boards, tables and chairs, in an elegant, organized custom grilling system. The options are unlimited, with additional heights you may grill standing or sitting; with additional corners and tables, you can extend the grilling system without limits. Use it camping, tailgating, in the backyard, or at an outdoor concert. Its compact easy-to-set-up and dismantle design makes this the ultimate outdoor cooking system.

### IGT Weekender Set IGT-001

**Weight:** 46 lbs  
**Dimensions:** Sitting height  
**Includes:** Large BBQ Box, Baja Single Burner Stove, Stainless Steel Inserts, Canvas Carrying Case



### IGT Tailgater IGT-002

**Weight:** 70 lbs  
**Dimensions:** Sitting height  
**Material:** Large BBQ Box, Baja Single Burner Stove, Stainless Steel Inserts, Bamboo Corner Extension, Long Bamboo Table, Canvas Carrying Case



### IGT Set-3 IGT-004

**Weight:** 50 lbs  
**Dimensions:** Sitting height legs  
**Includes:** Large BBQ Box, Baja Single Burner Stove, Stainless Steel Inserts, 2 Bamboo Side-tables, Canvas Carrying Case



## Creating a Custom IGT

When customizing your IGT set, you first start with your frame, choosing the size that best fits both your cooking needs and party size. Next, determine if you want to grill standing or sitting, by choosing between the two leg heights. After that pick out your cooking appliances and accessories. We believe that luxury camping starts with your kitchen, so don't hold back!

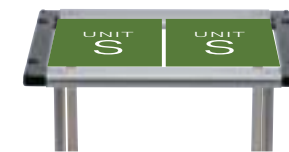

### Two-Unit Frame CK-170

**Weight:** 7.5 lbs  
**Dimensions:** 23.5" long X 20" wide  
**Material:** Aluminum, stainless steel, plastic

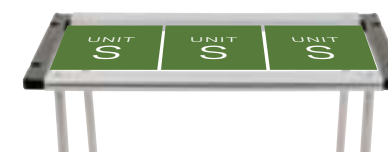

### Three-Unit Frame CK-149

**Weight:** 9.8 lbs  
**Dimensions:** 34" long X 20" wide  
**Material:** Aluminum, stainless steel, plastic



### Four-Unit Frame CK-150

**Weight:** 10.6 lbs  
**Dimensions:** 43" long X 20" wide  
**Material:** Aluminum, stainless steel, plastic



### IGT 660 Leg pair (sitting) CK-113

**Combined Weight:** 2.2 lbs  
**Dimensions:** 1" diameter 26" tall



### IGT 830 Leg pair (standing) CK-114

**Combined Weight:** 3 lbs  
**Dimensions:** 1" diameter 33" tall

IGT Frame/Leg Sets	Two-Unit	Three-Unit	Four-Unit
<b>660 mm (Sitting Legs)</b>	Ck-144	Ck-145	Ck-146
<b>830 mm (Standing Legs)</b>	N/A	Ck-147	Ck-148



# IGT Inserts

## IGT Stainless Tray Set CK-120

**Weight:** 1.7 lbs (each)  
**Dimensions:** 14" long X 5" wide (each)  
**Material:** Stainless steel



## IGT Bamboo Insert CK-125T

**Weight:** 1.7 lbs  
**Dimensions:** 14" long X 10" wide  
**Material:** Bamboo



## Barbecue Box CK-130

**Weight:** 11 lbs  
**Dimensions:** 14" long X 9.75" wide  
**Material:** Stainless steel



## Baja Single Burner Stove GS-400

**Weight:** 6.2 lbs  
**Dimensions:** 14" long X 9.8" wide  
**Material:** Stainless steel, aluminum, brass  
**Output:** 12,000 BTU's



## Large Barbecue Box CK-160

**Weight:** 21.3 lbs  
**Dimensions:** 14" long X 19.7" wide  
**Material:** Steel, stainless steel,  
 Grill net height adjustable range: 0 - 2.75 inches



## Double Burner Stove CK-119T

**Weight:** 15.5 lbs  
**Dimensions:** 14" long X 19.75" wide  
**Material:** Stainless steel, aluminum, brass  
**Output:** 11,200 BTU's



## IGT Wide Bamboo Insert CK-126T

**Weight:** 3.5 lbs  
**Dimensions:** 14" long X 20" wide  
**Material:** Bamboo



## Li Stove Joint Kit GP-040

**Weight:** 2.2 lbs  
**Dimensions:** 14" long X 14" wide  
**Material:** Stainless steel

**This unit allows you to use the Li Camping Stove in your IGT**

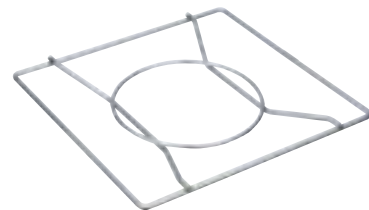

# IGT Extensions

## IGT Long Bamboo Table CK-117T

**Weight:** 12.5 lbs  
**Dimensions:** 3.6' long X 1.7' wide  
**Material:** Bamboo, aluminum, stainless steel



## IGT Short Bamboo Table CK-117T

**Weight:** 10.1 lbs  
**Dimensions:** 2.8' long X 1.7' wide  
**Material:** Bamboo, stainless steel, Canvas



## Bamboo Left Corner CK-118T

**Weight:** 5.2 lbs  
**Material:** Bamboo, aluminum, stainless steel



## Bamboo Right Corner CK-119T

**Weight:** 5.2 lbs  
**Material:** Bamboo, aluminum, stainless steel



## IGT Long Side Extension CK-154T

**Weight:** 2.6 lbs  
**Dimensions:** 8.6" long X 21.6" wide  
**Material:** Bamboo, Aluminum



## IGT Side Tray CK-127

**Weight:** 1.9 lbs  
**Dimensions:** 20" long X 7.5" wide  
**Material:** Stainless steel





# Pack & Carry Fireplace

The Pack & Carry Fireplace is designed to keep fire where it's supposed to be while preserving the natural environment you worked so hard to enjoy. Available in 3 different sizes and dozens of grilling configurations. Check out all the options at: [www.snowpeak.com](http://www.snowpeak.com)



**Pack & Carry Fireplace (M)**  
ST-032



**Pack & Carry Fireplace (S)**  
ST-031S



**Pack & Carry Fireplace (L)**  
ST-032



**Fire Place Grill**

ST-032GN

**Weight:** 2.8 lbs  
**Dimensions:** 19.4 X 13.4 X 0.8 inches  
**Material:** Chrome coated stainless steel

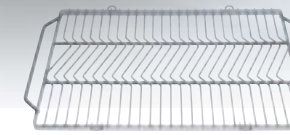

**Fireplace Grill Bridge**

ST-032GB

**Weight:** 3.7 lbs  
**Dimensions:** 17.8 X 17.8 X 6 inches  
**Material:** Chrome coated stainless steel

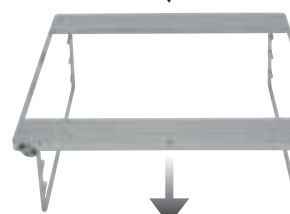

**Fireplace Grill Bridge (S)**

ST-031GN

**Weight:** 2.2 lbs  
**Dimensions:** 11.6 X 13.2 X 4.9 inches  
**Material:** Chrome coated stainless steel

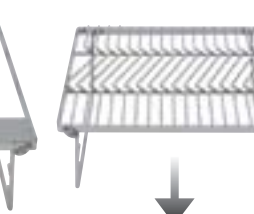

**Coal Bed**

ST-032S

**Weight:** 8.6 lbs  
**Dimensions:** 12.4 X 12.4 X 0.8 inches  
**Material:** Cast Iron



**Coal Bed (S)**

ST-031S

**Weight:** 3.1 lbs  
**Dimensions:** 7.6 X 7.6 X 0.8 inches  
**Material:** Cast Iron



**Pack & Carry Fireplace**

ST-032

**Weight:** 11.7 lbs, 11 oz  
**Dimensions:** 17 X 17 X 13 inches  
**Material:** Stainless Steel



**Pack & Carry Fireplace (S)**

ST-031S

**Weight:** 4 lbs  
**Dimensions:** 10.6 X 10.6 X 8.25 inches  
**Material:** Stainless Steel



**Base Plate**

ST-032BP

**Weight:** 4.2 lbs  
**Dimensions:** 18 X 18 X 0.4 inches  
**Material:** Steel



**Base Plate (S)**

ST-031BP

**Weight:** 1.98 ounces  
**Dimensions:** 11.4 X 11.4 X 0.4 inches  
**Material:** Steel



**Carrying Case**

ST-032BR

**Weight:** 1.3 lbs  
**Material:** Canvas #6, nylon mesh, plastic



**Carrying Case (S)**

ST-031BR





# Shelters



## Hexa Tarp

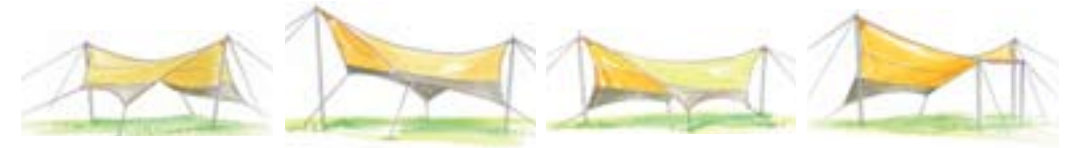
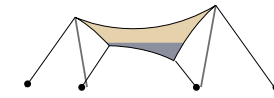
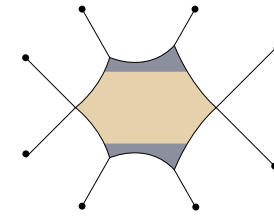

### Hexa Tarp Large Pro TP-762S

**Contents:** Tarp, Wing Pole, 4 Solid Stakes 40, 4 Solid Stakes 30, Rope With Stopper, Peg Hammer Pro C, Pole Case, Rope Case, Peg And Hammer Case, Carrying Case, Carrying Case  
**Weight:** 21.6 lbs  
**Capacity:** 4 to 6 people comfortably

### Hexa Tarp Medium Pro TP-761S

**Contents:** Tarp, Wing Pole, 4 Solid Stakes 40, 4 Solid Stakes 30, Rope With Stopper, Peg Hammer Pro C, Pole Case, Rope Case, Peg And Hammer Case, Carrying Case, Carrying Case  
**Weight:** 20.9 lbs  
**Capacity:** 2 to 4 people comfortably

## Recta Tarp

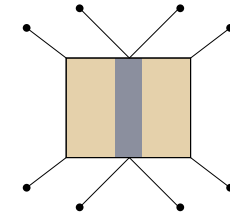

### Recta Tarp Large Pro TP-762S

**Contents:** Tarp, Wing Pole, 4 Solid Stake 40, 4 Solid Stake 30, Rope With Stopper, Peg Hammer Pro C, Case Carrying Case  
**Weight:** 29.5 lbs  
**Capacity:** 5 to 8 people comfortably

### Recta Tarp Medium Pro TP-761S

**Contents:** Tarp, Wing Pole, 4 Solid Stake 40, 4 Solid Stake 30, Rope With Stopper, Peg Hammer Pro C, Case Carrying Case  
**Weight:** 26 lbs  
**Capacity:** 3 to 4 people comfortably

## Penta Tarp

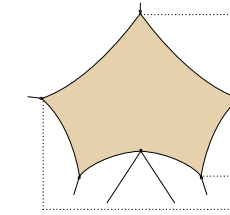
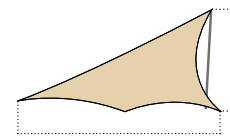

Trekking pole

Kayak paddle

Canoe paddle

Penta Ease SDI-001 (\$89.95)

### Penta Tarp SDI-001



### Tarp Poles 150 TP-160



## Ponta Tarp

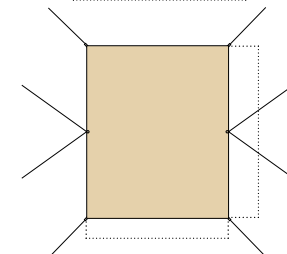
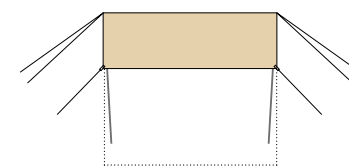

Variation 1

Variation 1

Variation 1

Variation 1

### Ponta Tarp STP360

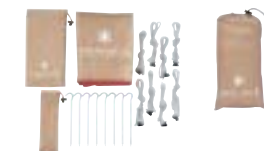

### Tarp Poles 125 TP-161





Amenity Dome Series

Mesh Shelter Series

Landbreeze Series

Landlock Series

**Amenity Dome SDE-001-US**

**Contents:** tent, rainfly, stakes, tent and entrance poles, rope with stopper, carrying case  
**Weight:** 19.6 lbs  
**Capacity:** 3-4 people comfortably

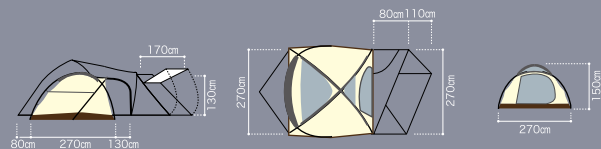

**Amenity Dome S SDE-002-US**

**Contents:** tent, rainfly, stakes, tent and entrance poles, rope with stopper, carrying case  
**Weight:** 10.8 lbs  
**Capacity:** 2-3 people comfortably

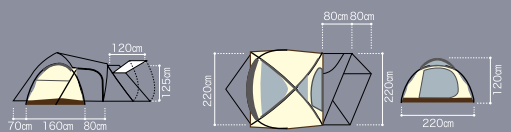

**Mesh Shelter TP-920**

**Contents:** tent-shelter, stakes, poles, rope with stoppers, carrying case  
**Weight:** 26.5 lbs  
**Capacity:** 4 people comfortably dining/cooking

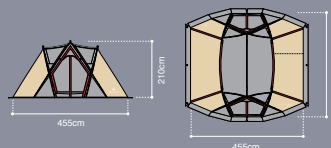

**Mesh Shelter Roof TP-920SR**

**Includes:** Carrying Case  
**Material:** 75D Polyester taffeta PU coating water resistance 3,000mm minimum, UV coating  
**Weight:** 2.5 lbs

*Protect your tent from the harsh UV rays that will deteriorate your tent while adding rain protection.*

**Living Shell Tunnel TP-920T**

**Material:** 75D Polyester taffeta PU coating water resistance 3,000mm minimum, UV coating  
**Weight:** 2.2 lbs  
**Function:** connects Mesh shelter to landbreeze tent

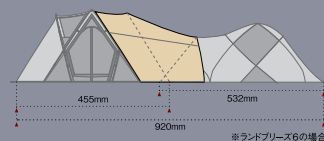

**Living Shell Inner Room TP-622T**

**Material:** 68 D Polyester taffeta, breathable and water repellant / floor= 210D Polyester OX, water resistance 1,800 mm minimum  
**Weight:** 7.7 lbs  
**Includes:** Inner Tent, 6 duraluminum pegs, carrying case  
**Capacity:** Sleeps 4

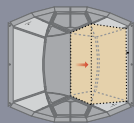

**Landbreeze 4 SD-604**

**Contents:** tent, rainfly, 3 long poles, 1 short pole, 23 Duraluminum pegs, rope with stopper, seam sealant, carrying case, instruction manual  
**Weight:** 12.5 lbs  
**Capacity:** 3-4 people comfortably

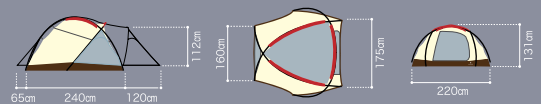

**Landbreeze 6 SD-606**

**Contents:** tent, rainfly, 3 long poles, 1 short pole, 16 Duraluminum pegs, rope with stopper, seam sealant, carrying case, instruction manual  
**Weight:** 20 lbs  
**Capacity:** 3-4 people comfortably

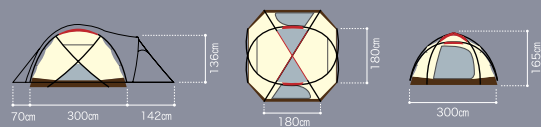

**Land Lock TP-670**

**Contents:** shelter, inner tent, 6 aluminum poles, 29 duraluminum pegs, rope with stopper, seam sealant, pole case, shelter case, instruction manual  
**Weight:** 48.5 lbs  
**Capacity:** Sleeps 4 people, dining/cooking 8-10 people

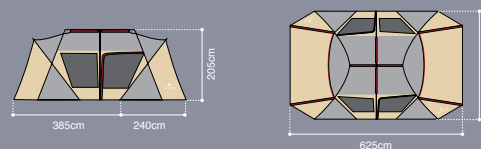

**Land Lock Awning Pole Set TP-080**

**Contents:** 2 X 6'3" aluminum poles, rope and stoppers, 4 X 8" duraluminum pegs  
**Weight:** 6 lbs

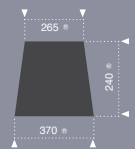

# Camping Stakes & Hammers



**Solid Stakes 50 R-105**  
 Material: S55C Steel, Black electro-deposition coating  
 Length: 19 3/4 inches



**Solid Stakes 40 R-104**  
 Material: S55C Steel, Black electro-deposition coating  
 Length: 15 3/4 inches



**Solid Stakes 30 R-103**  
 Material: S55C Steel, Black electro-deposition coating  
 Length: 11 7/8 inches



**Solid Stakes 20 R-102**  
 Material: S55C Steel, Black electro-deposition coating  
 Length: 7 7/8 inches

Our Solid Stakes are designed with the roughest terrain in mind. The material and design is made to bust through concrete and the toughest terrains.



**Peg Hammer Pro N-001**  
 (With copper head)  
**Weight:** 1.4 lbs  
**Dimensions:** 1 1/4 X 4 3/4 X 11 1/2 inches  
**Material:** Copper and steel head, oak handle

**Peg Hammer N-002**  
 (With steel head)  
**Weight:** 1.4 lbs  
**Dimensions:** 1 1/4 X 4 3/4 X 11 1/2 inches  
**Material:** Steel head, oak handle



The round hole is convenient for pulling the stake out of the ground. It is designed to catch on the hook of the Peg Hammer Pro.







## GUARANTEE

Lifetime Ownership  
Our promise to you

Snow Peak submits all of its products to the highest standards of engineering and testing, to ensure long-lasting durability in even the most challenging outdoor conditions. Our company proudly takes full responsibility for the high quality of our products.

If you ever find that one of our products doesn't function properly, simply contact Snow Peak User Services, or take it to one of our certified dealers. If we find that the product didn't live up to our standards, we'll repair it or exchange it free of charge. In other cases, we'll provide the necessary repairs for a reasonable fee. Please understand that we will not be able to repair damage caused by unreasonable usage or, in certain cases, the natural lifespan of the product. It is important that you read the user manual for each product before use.

If anything is unclear or a product requires service, we will be happy to answer any questions through Snow Peak User Services or any of our certified dealers.

## ENVIRONMENTAL STATEMENT

At Snow Peak we are always conscious of the natural environment. Our workplace is nestled in the foothills of the Japanese Alps, one of the most stunning natural landscapes of Japan. For decades, our company has dedicated itself to the care and protection of the environment, seeking to nurture and maintain the natural world in everything we do.

With this philosophy, we create durable tools intended to last. We want our customers to use our tools for many years to come, and so we work together with our customers to care for these tools over the long term. In order to help maintain a sustainable environment, Snow Peak makes extensive use of bamboo in our products: bamboo plants grow and mature rapidly, providing a more quickly renewable resource than wood.

We constantly seek out new innovations that will sustain the earth and support the environment.



# Addresses

## **Snow Peak - USA**

16081 SE 98th Ave  
Clackamas, OR 97015  
United States

TEL: 503.697.3330  
FAX: 503.699.1396  
WEB: [www.snowpeak.com](http://www.snowpeak.com)

## **Snow Peak HQ - Japan**

456 Nakanohara,  
Sanjo-CityNiigata 955-01467  
Japan

TEL: +81 256-46-5858  
FAX: +81 256-5968  
WEB: [www.snowpeak.co.jp](http://www.snowpeak.co.jp)

## **Snow Peak - Europe**

Krampenhausweg 1  
40882 Ratingen,  
Germany

TEL: +49 (0) 2102 6102840  
FAX: +49 (0) 2102 6102852  
WEB: [www.snowpeak.eu](http://www.snowpeak.eu)

## **Snow Peak - Korea**

718-21, Building 9F  
Yeoksam-dong, Gangnam-ga,  
South Korea

TEL: +82 31.959.9879  
FAX: +82 31.942.4223  
WEB: [www.snowpeak.co.kr](http://www.snowpeak.co.kr)