

# Lockable Loudspeaker Connector

Speakon® SPX Series  
NL4FX / NL4FRX

## Assembly Instructions

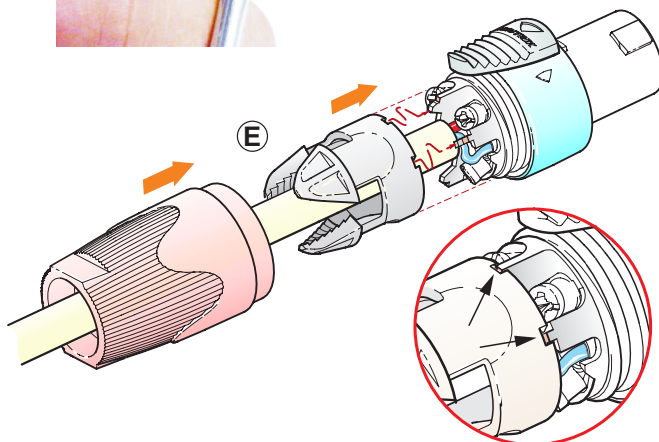
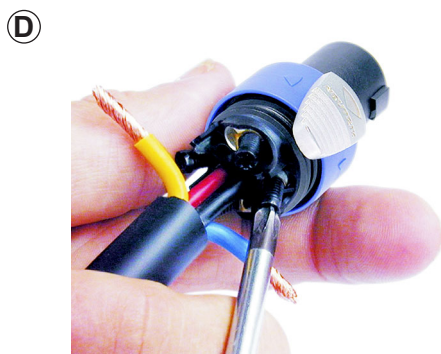
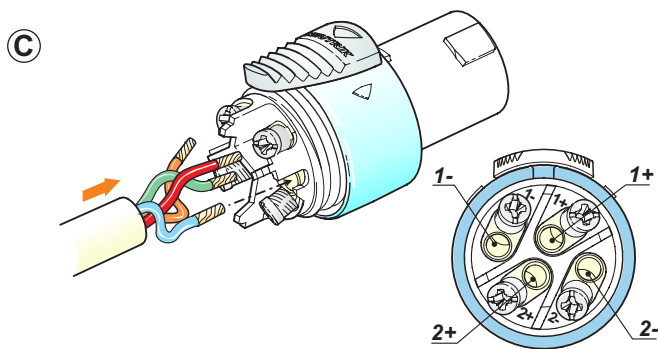
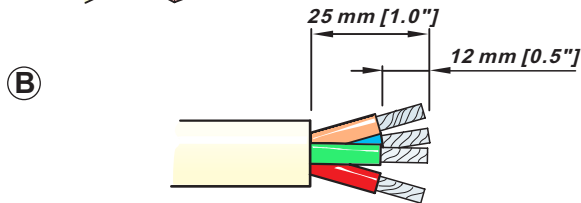
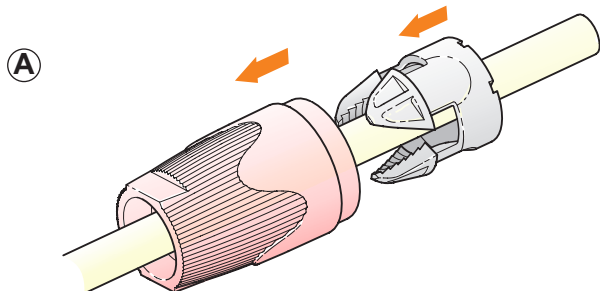

### Assembly of the Connector:

- Ⓐ Place bushing and chuck over cable.
- Ⓑ Prepare cable as shown.  
*Important is the stripping length of 25 mm and 12 mm.*
- Ⓒ Insert wires into terminals and secure clamp terminals with screw driver (Pozidrive®).
- Ⓓ For easy wiring especially on big cables, first screw on the inner contacts 1+ and 2+ and afterwards the outer contacts 1- and 2- !
- Ⓔ Push chuck up to housing .  
**Important:** Align the chuck by positioning the nose into the recess.
- Ⓕ Tighten the bushing

### INFO to the screw driver:

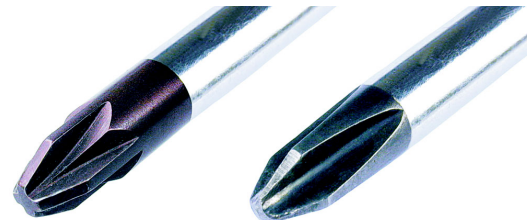

**DO NOT USE!**

Pozidrive #1

Philips

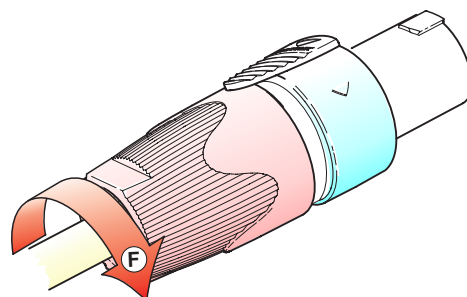

## Assembly of the Conversion Kit:

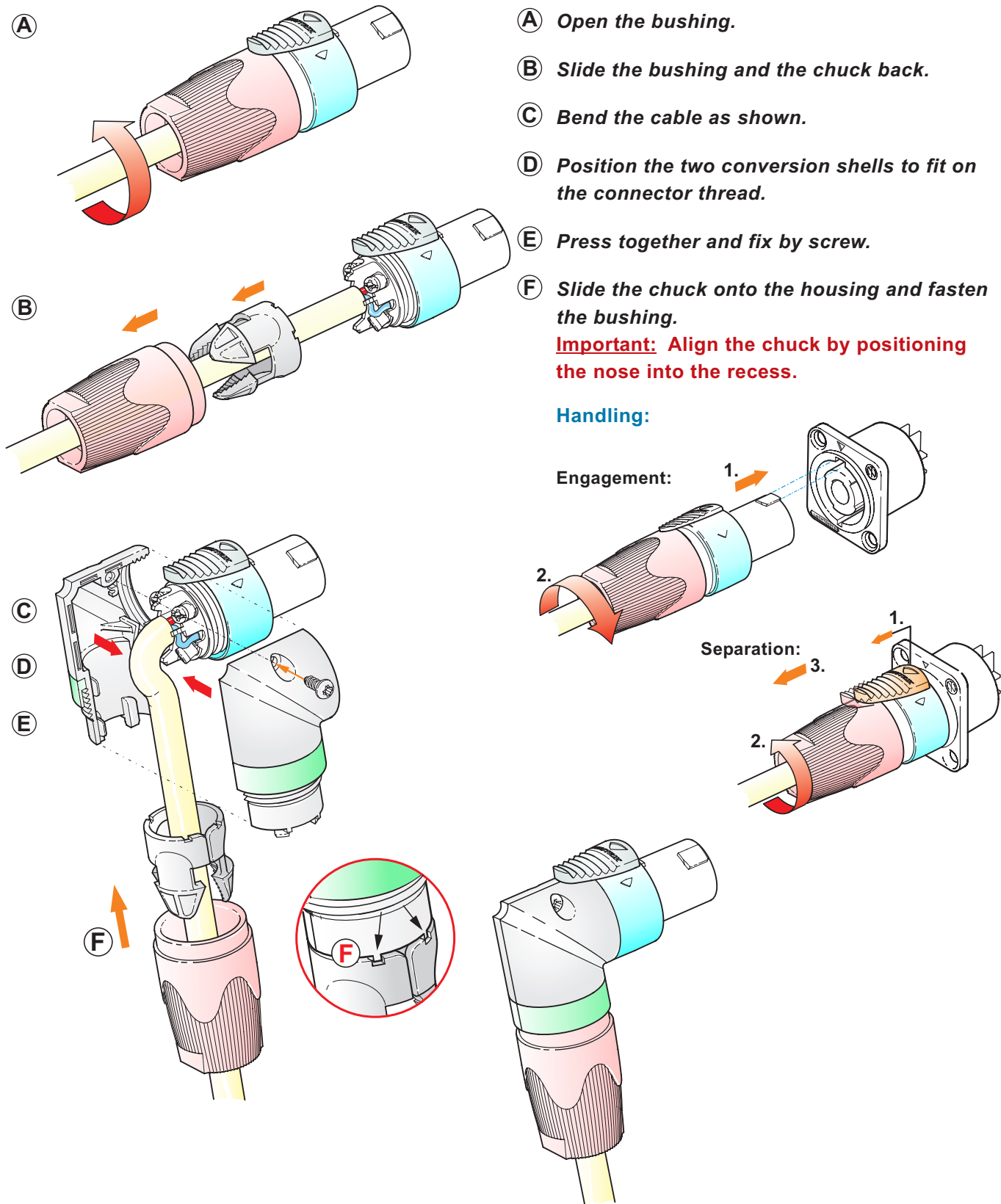

**NEUTRIK AG**  
Liechtenstein  
Tel.: +423/237 24 24  
Fax: +423/232 53 93  
www.neutrik.com

**NEUTRIK Zürich AG**  
Switzerland  
Tel.: +41 1/736 5010  
Fax: +41 1/736 5011

**NEUTRIK (UK) Ltd.**  
Great Britain  
Tel.: +44 1983/811 441  
Fax: +44 1983/811 439

**NEUTRIK USA INC.**  
USA  
Tel.: +1 732/901 9488  
Fax: +1 732/901 9608

**NEUTRIK Tokyo Ltd.**  
Japan  
Tel.: +81 3/3663 4733  
Fax: +81 3/3663 4796

**NEUTRIK France**  
France  
Tel.: +33 1/4131 6750  
Fax: +33 1/4131 0511

**NEUTRIK Vertriebs GmbH**  
Germany / Netherlands  
Tel.: +49 8131/28 08 90  
Fax: +49 8131/28 08-30

Draft. Nr.: BDA 114 / 3102M1171  
Update: 25.02. 2005

Data subject to change without prior notice. ©2005 NEUTRIK®. ALL RIGHTS RESERVED.



**NEUTRIK®**  
CONNECTING THE WORLD