

safari collection
photo and birdwatching

GITZO

focus on forever

2010 - 2011 collection

safari

Safari is the new Gitzo's range specifically dedicated to bird-watchers and outdoor photographers.

A premium selection of tripods and heads completely resistant to natural elements, developed for the professionals who look for ultra stable and precise solutions.

Head systems achieve maximum control to all movements and exactly speed you need, eliminating even the smallest unwanted give and play.

This is very useful when a fast equipment repositioning is required. Tripods have special waterproof leg locks, to withstand to extreme conditions, blocking water, mud or sand.

They have inserts at both ends, minimizing outside elements that may enter tubes and locking mechanism. Solid, lightweight, compact, Safari are in black, green and brown color to allow the best mimetism in nature.

A very nice and elegant collection, easy to match with most popular outdoor accessories, clothing and equipment.

Ready to adapt to your challenges, ready to give you the best results.



see the front cover fold-out for more information

high tech materials



carbon fiber tube - 6X multilayer technology

Gitzo 6X is the most advanced carbon fiber tube in the market and guarantees structural strength, flexion rigidity and great vibration absorption properties. Despite the claims of other manufactures, the performance of this multilayer design is unique and inimitable thanks to the advanced aerospace production technology and the exclusive inner structure. It is the highest density tube 100% made of top quality ultra thin ($7\mu\text{m}$) carbon fibers (a 28mm tube contains 1.500.000 carbon fibers).

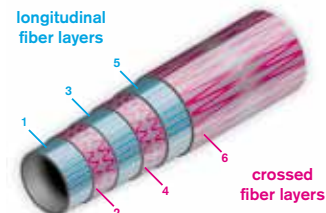

magnesium – lightweight core

In 1996 Gitzo was the first to use Magnesium in camera supports. Magnesium comes in different grades and Gitzo only uses material of the highest grade quality. It offers significant weight savings being 30% lighter than aluminum. In our magnesium casting every functional bolt and screw works on threads reinforced by high quality steel inserts for a lifetime performance.

material weight comparison

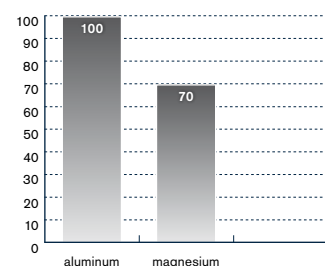

PTFE – smooth as silk

PTFE is a special treatment that generates a unique ultra smooth surface and dramatically reduces friction between moving parts. This treatment bonds strongly with metal surfaces and ensures long-lasting performance. PTFE is one of the lowest-friction materials known to science, with the same friction coefficient as melting ice. This treatment is now applied not only to ball heads, but also to plates, video bowls and other sliding parts for smooth, precise and fine movements.

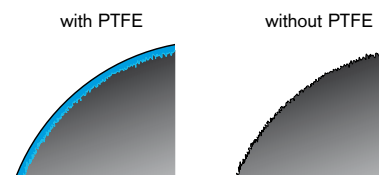

symbols



Column type



Leg sections



Maximum height with extended center column



Maximum height column down



Minimum height



Closed height



Weight



Max load capacity



Height



Travel



Monopod max height



Monopod min height





all about Gitzo	since 1917	5
	design and manufacturing	6
	inside tripod technology	8
	inside head technology	10
	the gitzo series concept	12
	safari range	13

all about Gitzo

safari heads	bird watching heads	16
	photo heads	18

safari heads

safari tripods	mountaineer tripods	22
----------------	---------------------	----

safari tripods

safari traveler	bird watching kit	24
-----------------	-------------------	----

bird watching kit

accessories & photo gear	tripod accessories	28
	head accessories	29
	apparel	30
	carrying solutions	32

accessories & photo gear

insights	materials	1
	features	43
	product index & summary chart	40
	spare parts & coding system	42

insights



focus on forever

since 1917

GITZO

Gitzo was founded in France in 1917 by Arsène Gitzhoven, who produced cameras, cable releases, shutters (at a rate of 750 per day) and film-pack frames for the photographic industry until 1942, when the World War led to the company being temporarily dismantled.

Production started again in 1944 and tripods were introduced to the Gitzo's product range in the 1950's.

In 1960, Arsène Gitzhoven retired and his daughter, Yvonne Plieger, took over running the company with her husband,

devoting themselves to the development of a wide range of top quality tripods and heads which were exported to more than 54 countries.

In 1992, Gitzo became part of the Vitec Group - a multinational holding company specialized in supporting professional photographers, broadcasters and filmmakers. Gitzo's unfailing standards have helped to maintain the company's worldwide reputation for excellence in the photographic industry.

all about Gitzo



design and manufacturing

Professionals the world over acknowledge Gitzo tripods, monopods, heads and accessories as setting the industry's standards for excellence.

Innovations such as the first uses of carbon and basalt fiber to make tripods and magnesium to make heads, matched with a design policy of "no gimmicks and no compromise on quality" put Gitzo products in a class of their own.

Functional, versatile and timeless, even a Gitzo tripod purchased over 25 years ago is compatible with accessories available today and can still be serviced almost as though it were a brand new model. Gitzo's carefully crafted products make up a comprehensive range of supports for large, medium and small format cameras, for film or digital technology, for still photography or video, for studio or location work.

design

Combining a classic sense of style with modern ergonomics has kept Gitzo at the forefront of camera support system design.

renowned quality

Gitzo tripods and heads are superbly engineered to withstand the roughest handling. Precision assembly, high quality materials and fine control are all qualities that represent Gitzo products.

technology and materials

Gitzo has stayed at the cutting edge by utilizing space-age materials such as high strength, lightweight aluminum alloys, carbon and basalt fiber tubing and cast magnesium, to ensure absolute stability and efficiency.

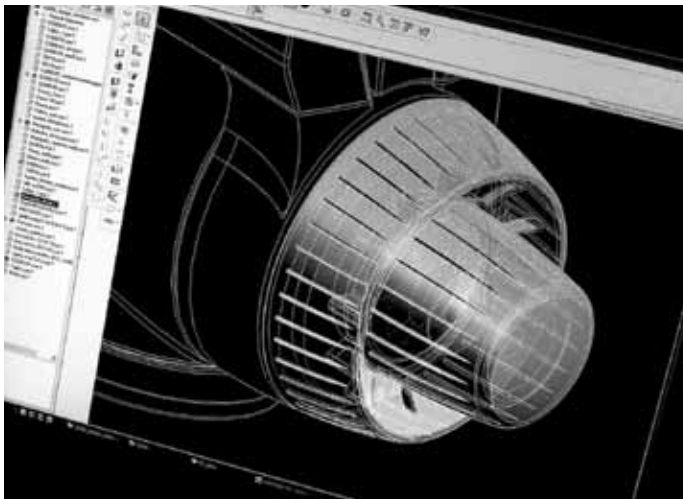

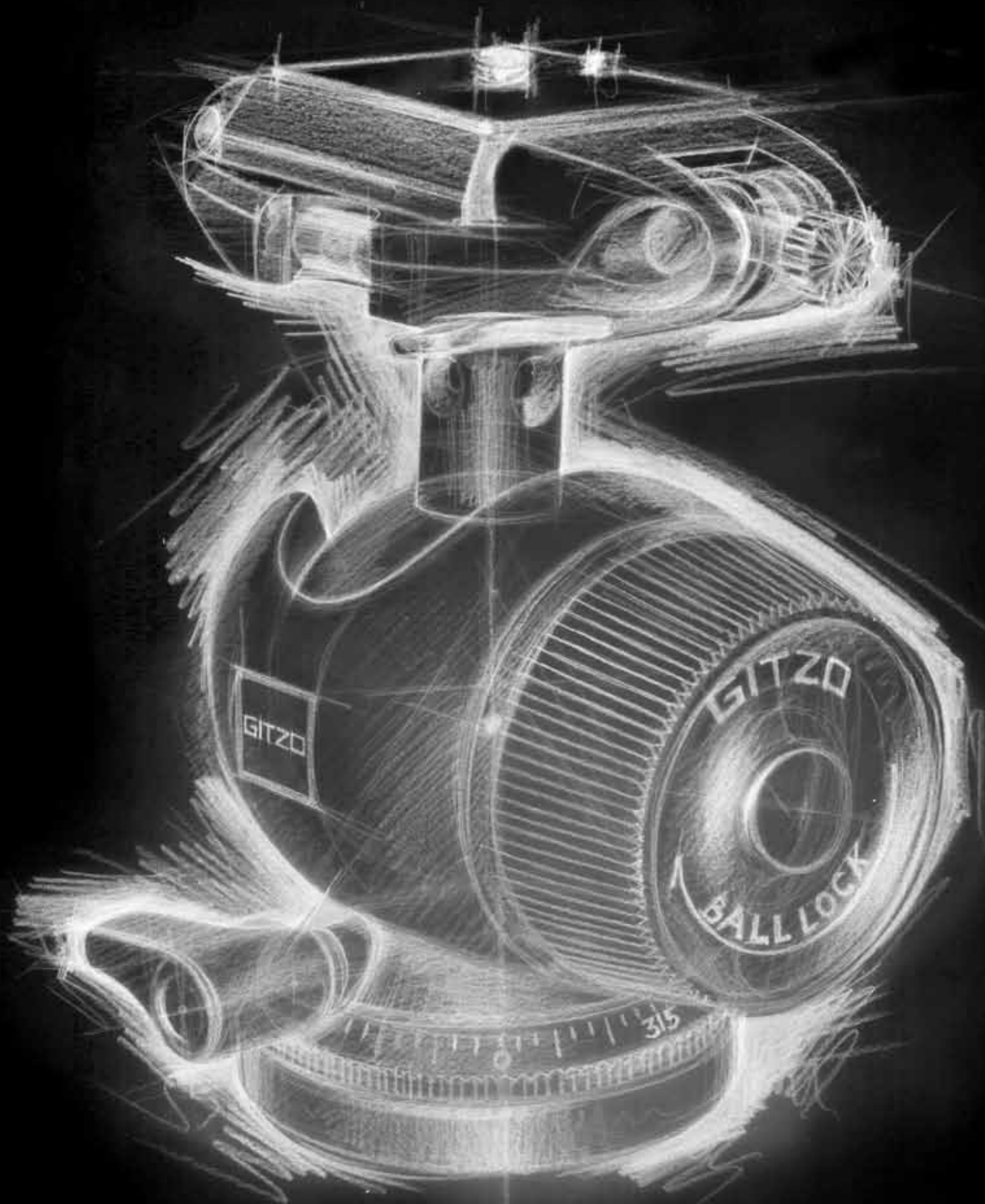

inside tripod technology

Gitzo's aim is simply to create the best tripods in the world. Our idea of "best" is shaped by the requirements and advice of the world's top professional photographers, experts who collaborate with us and test our products at every stage from the earliest

development prototype onwards so that their feedback, advice and strict criteria can guide our design and product strategies. And though empirical, objective data like weight or torsional rigidity are important, they aren't the only factors that contribute

power disc

The tripod's upper disc is made of machined aluminium, with a new Safe Lock insert that cuts vibrations and improves tripod-to-head lock (as already used on tripods discs). Series 2 and 3 tripods now come with the new aluminium "Power Disc" that features two locking screws, one for the disc on the column and one to securely lock the head onto the disc in order to ensure a stable and rock solid connection among all parts of your support system. All discs can be mounted directly to the tripod top casting (Ground Level Set feature). Additionally, the 1/4"-3/8" reversible screw has been redesigned for more reliable functionality.

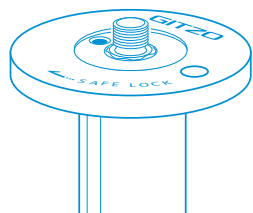

ground level set

For low angle shooting, the center column can be removed and the upper disc fitted directly to the tripod top casting. The disc is locked into position using the retractable column hook. The ground level configuration can be achieved in a few seconds without tools or extra components, and only the column need be removed. With this effective and simple built-in solution we've dramatically increased the ways you can use the tripod. The new generation of series 1, 2, 3 and Leveling tripods, thanks to the new ultra low leg position, can take full advantage of this feature. The Gitzo Ground Level Set is patent pending.

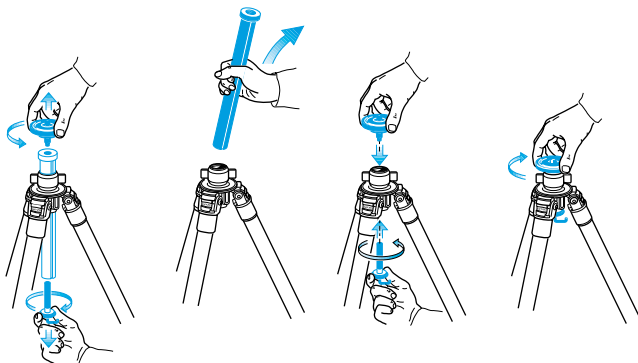

step 1
Disassemble disc, bolt and hook from the column.

step 2
Remove the column.

step 3
Assemble disc, bolt and hook onto the upper casting.

step 4
Tighten the ground level set by turning disc and column locking collar clockwise.

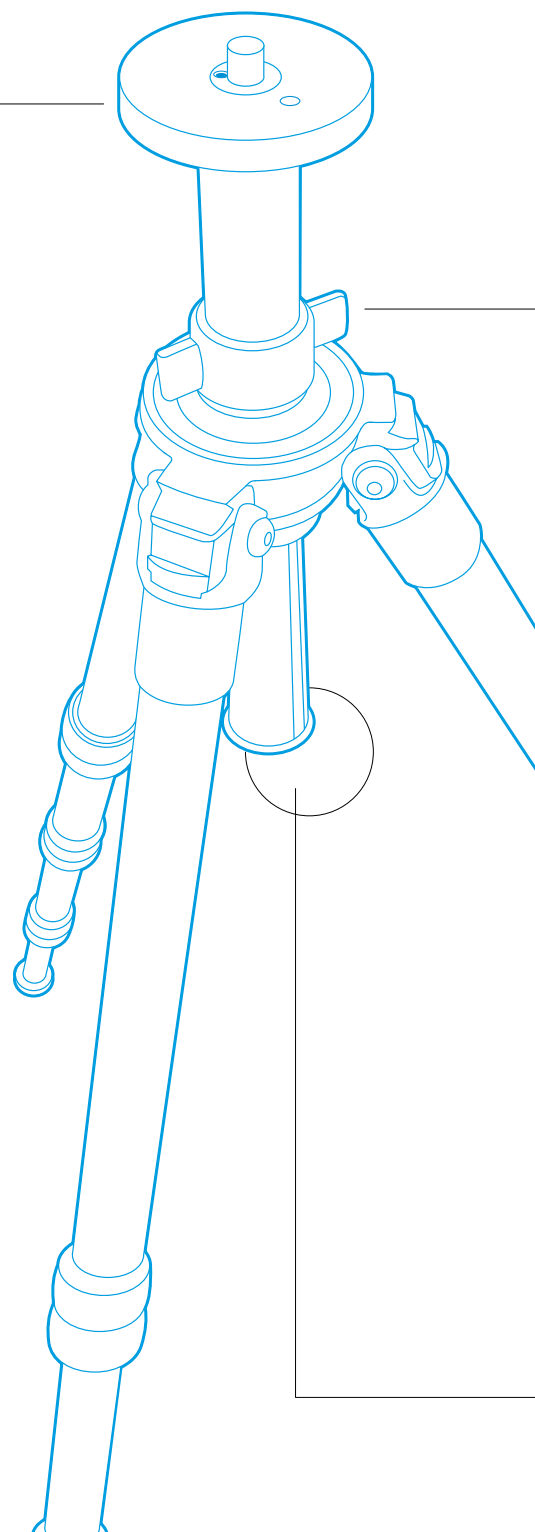
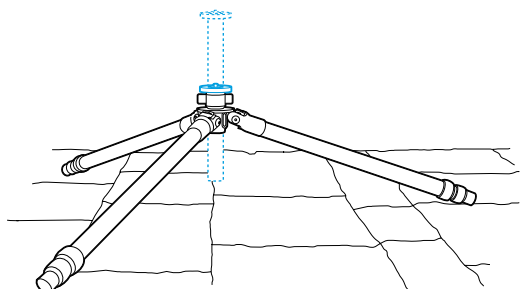

to a product's performance, so we and our field testers also consider a wealth of other aspects, from ergonomics and simplicity of use to reliability and manufacturing quality. A new solution is implemented only if it meets exacting standards

in all of these criteria; we'll never sacrifice one for another. This approach leads to uniquely high quality products, technologically advanced, intuitively user friendly, reliable and long lasting.

new ultra low leg position

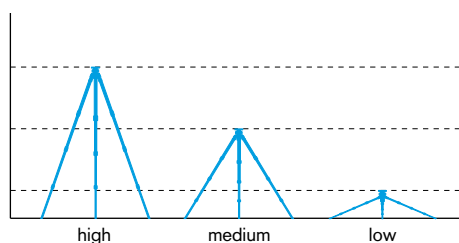

Series 1, 2, 3 and levelling tripods, now feature three different positions of leg openings: standard or high, medium and ultra low position. The ultra low position is new and it allows you to take full advantage of the Ground Level configuration, with the column removed and the disc directly attached to the upper casting. In ultra low position, the ground clearance of the tripod is around 8-10 cm (3.3 – 4 inches) to guarantee enough clearance on uneven surfaces.

materials



Gitzo tubes are developed and manufactured to the highest standards. Carbon Fiber and Basalt composite tubes are engineered using aerospace technology and are by far the best tubes on the market for camera support applications, uniquely developed by Gitzo. Furthermore, since the introduction of the new 1.2mm aluminum tube, Anti Leg Rotation is now available for tripods in all materials. For more detailed information, please see the front cover fold-out.

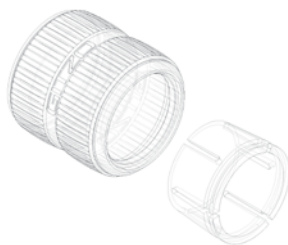

G-Lock

A revolutionary and unique locking system guarantees unsurpassed performance and ease of use. G-lock is patent pending

- Gravity effect
- 20% increased rigidity
- Faster operation
- Stronger lock

removable leg ends

Gitzo tripods and monopods feature a high quality system that enables you to remove and change the feet, choosing from a variety of options. Unlike all other tripods in the market, the system is based on a strong mechanical connection that guarantees durability and stability. In all Safari tripods the system is completely waterproof.

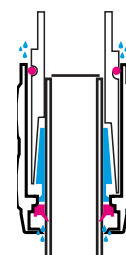

ocean-lock

The Ocean-Lock is a special version of Gitzo G-Lock of which it maintains the same outstanding locking performances. Thanks to two special seals derived from the automation industry, it minimises the amount of water and debris that may enter tubes and locking mechanisms. The Ocean-Lock is not 100% waterproof, however it dramatically enhances the capacity of the tripod to withstand extreme environments.



inside head technology

Gitzo is renowned for its beautiful range of high performance and quality tripods that represent the state of the art of the market. Now Gitzo is launching a completely new and innovative range of ball heads, engineered and developed to be the ideal complement to our top of the range tripods.

These new heads are the result of Gitzo's unique and long established unconventional approach of problem solving. We worked with top professional photographers and focus groups in order to establish the most important needs for ball heads, then we analyzed every head in the market in order to map performances and specifications.

quick release systems

The new center ball and systematic heads introduce a new generation of quick release systems. Both systems feature a new lever locking system for improved safety and compactness. The tension of the locking lever can be adjusted accordingly to the plate used by means of a small knob. The locking tension should be adjusted in order to keep the lever when closed, always completely folded in the rest position. Gitzo quick releases feature a double safety system that prevents the equipment from dropping out of the head when the plate is released.

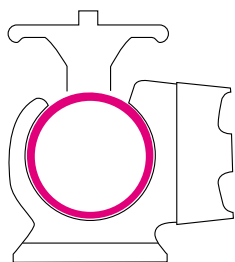
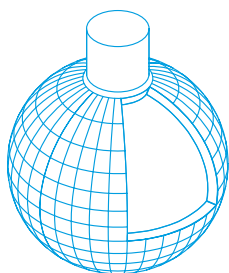

bubble ball

For center ball heads, the size of the ball is important to guarantee a smooth movement and a powerful lock. Until now a bigger ball had the disadvantage of being heavy: the bigger the heavier. For this reason the choice of the size of the ball has always been a compromise between weight and performance.

Several solutions have been proposed to solve this issue, but they have never been fully satisfactory. Gitzo has now developed a new exclusive technology that enables us to produce high quality, completely round hollow spheres, with an ultra thin wall, for an incredible weight reduction. The bigger the sphere the higher the weight advantage against competitors. This new and revolutionary Bubble Ball is now available in all the new center ball heads.

The Gitzo Bubble Ball not only guarantees a dramatic weight reduction, but it also allows us to increase the size of the ball for each series, with great improvements in the locking performance and in the smoothness of the movement.

Gitzo Bubble Ball also features a perfected PTFE treatment that further reduces the surface micro roughness for the ultimate shooting experience and accuracy.

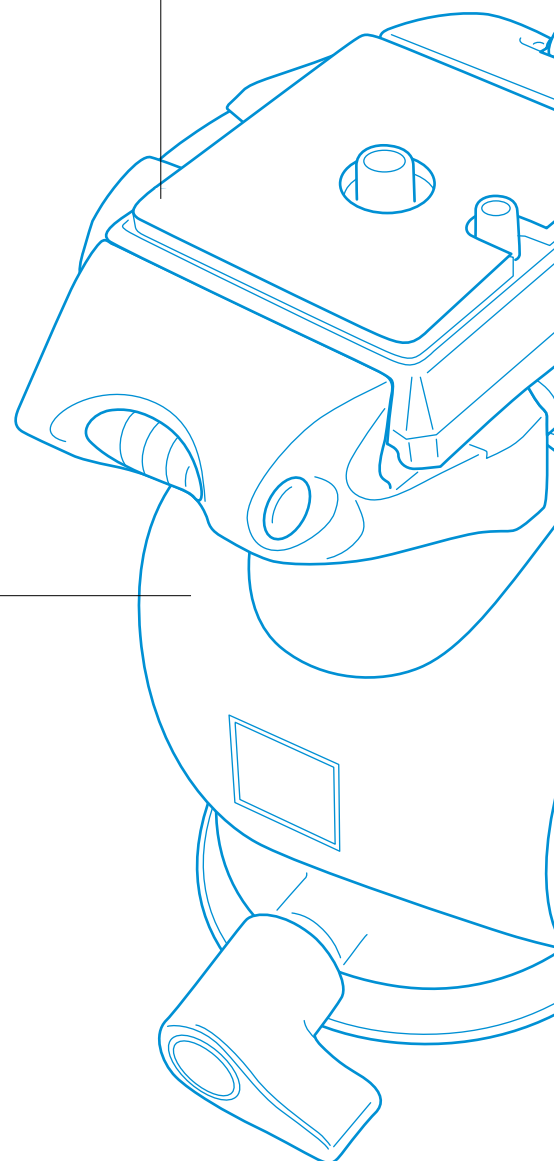

bird watching fluid cartridge

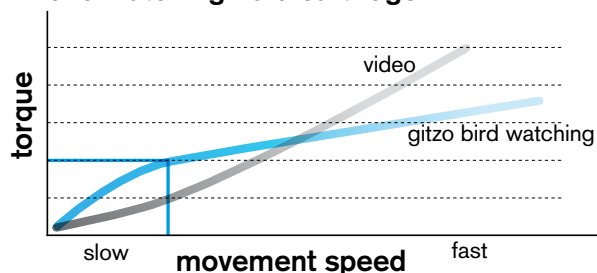

The new Pan and Tilt Fluid cartridges, exceptionally lightweight and compact, are specifically developed for bird watching. At very low speed they offer an ultra-smooth and controlled movement, while at high speed, when a rapid equipment repositioning is required, the movement becomes almost completely free.

The findings of this process lead to new technologies and features in order to completely fulfil our customers' expectations. The new heads not only maximize max pay load performance, but also offer the excellence in all the other key aspects, such as smoothness, minimized drift angle, lightweight, low gravity center, compactness, ergonomics and safety.

Like Gitzo's tripods, the new heads offer the best weight to max load ratio in the market, and this makes Gitzo equipment the lightest one for top performance and enjoyment.

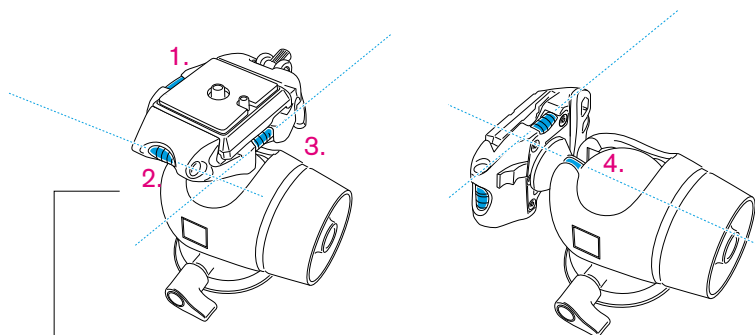

advanced bubble leveling system

The new quick release center ball heads feature a unique advanced system of leveling bubbles.

This system allows the user to precisely control the leveling of his shots in any position and conditions, in both portrait and horizontal position, with both short and long lenses.

The heads feature 4 leveling bubbles, three on the quick release plate and one in a new exclusive position, in the ball stem.

This innovative bubble in the ball stem is specifically designed to assist you in controlling the horizon in portrait position.

The other three bubbles on the plate ensure that you always have one bubble in front of you and one bubble on the side for both horizontal and portrait leveling accuracy, no matter if the plate is used longitudinally or at 90° to your shooting axis.



Magnesium comes in different grades and Gitzo only uses material of the highest degree of quality. It offers significant weight savings in being 30% lighter than aluminium. In our magnesium casting, every functional bolt and screw works on treads reinforced by high quality steel inserts for a lifetime of excellent performance.

locking systems

The new 2008 head range features two innovative locking systems: one mechanical and one hydraulic.

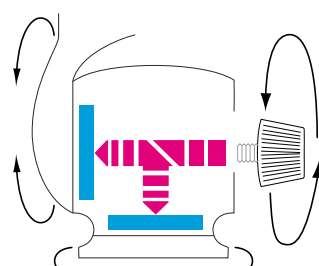

■ pan & tilt locks
■ twin mechanical control

single lock

Single lock is the other specific innovation for bird watching. Pan and Tilt movements are locked and frictioned in parallel by a single large knob, making head control simple, fast and effective as never before.

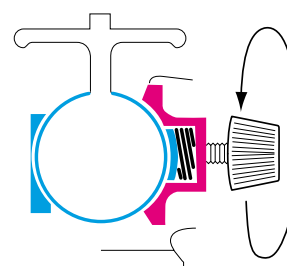

■ metal plate
■ teflon bushings
■ mechanical control

spring assisted double lock

The new center and off center ball heads feature a mechanical system called SADL (Spring Assisted Double Lock) that for the first time maximizes both locking power and smoothness of movement thanks to a completely new concept.

This unique and patent pending system combines two locking systems in one. When the head needs to be fully locked, the sphere is compressed by a high friction metal to achieve a high efficiency lock. In all intermediate positions the sphere works on PTFE bushings that maximize smoothness and control.

The PTFE bushing is controlled by a preset spring. The efficiency of the system is further increased by the ultra wide locking pads that exist on the largest diameter of the sphere, thus ensuring a much higher max pay load for given ball diameter compared to competitors' systems.

the gitzo series concept

Gitzo's way of classifying and coding its product range is worth a little attention. Gitzo products across all main categories are divided into Series - the first digit of the product code normally indicates to which Series the product belongs to. Series numbers communicate a wealth of information about the product; as in the automotive industry, our Series numbers allow customers to quickly identify each product's class, size, performance, compatibility and, to a certain extent, intended use. The concept behind the Gitzo Series is unique in the camera support market,

but once familiar, makes it much easier to navigate our product range and select the right support for your equipment. A higher Series number corresponds to higher maximum load capacity and performance. By using a tripod and a head that belong to the same Series, you can be sure both components are compatible. We would never recommend that you use a higher Series head together with a lower Series tripod, but some applications may favour the use of a lower Series head with a higher Series tripod (eg. a Series 1 head with a Series 2 tripod).

series concept

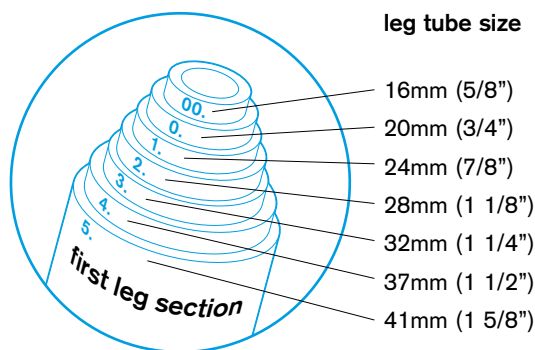
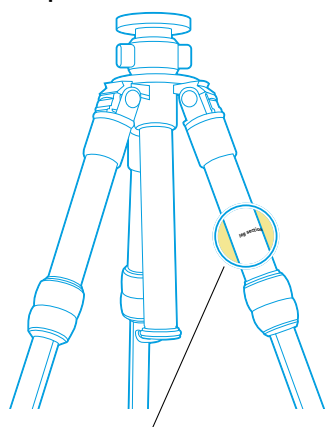

series number

00.
0.
1.
2.
3.
4.
5.

tripod max. load by series

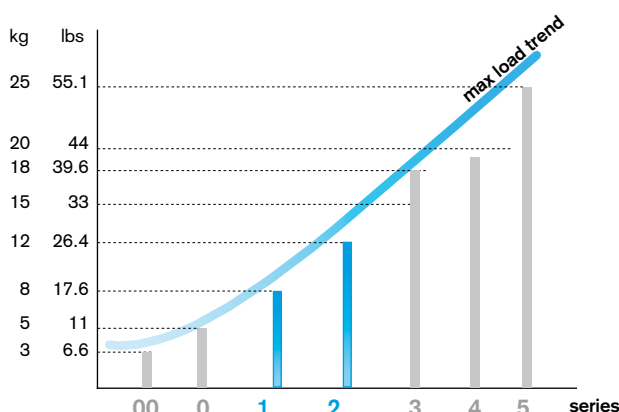

A higher Series number corresponds to a higher maximum payload. The maximum loads of heads are generally lower than those of tripods because tripods often need to withstand additional loads and stress caused by sand bags or back packs hung from the tripod column hook for additional stability, strong winds, water etc.

tripod height by series

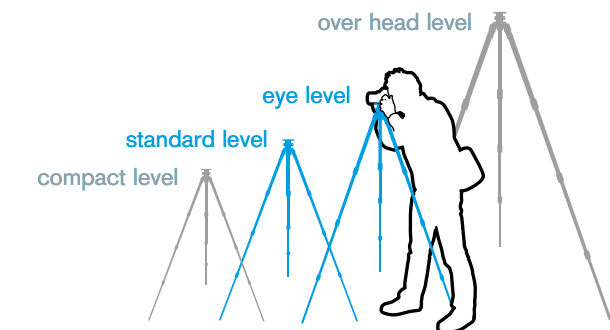
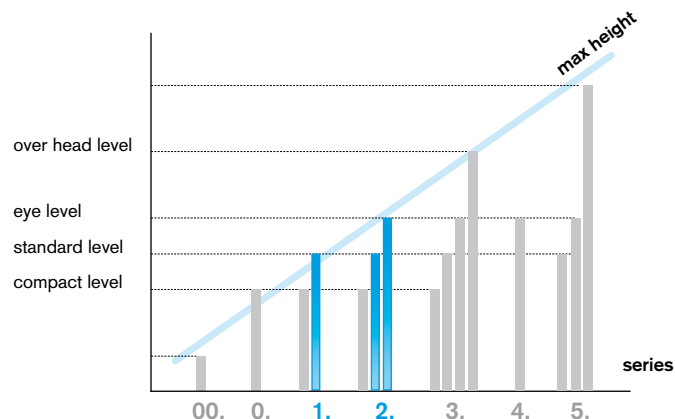

Tripod heights are aligned to 4 height levels: Compact, Standard, Eye Level and Over Head. A higher Series can offer taller tripods, but different heights are also available for each Series. In this way it is possible to independently choose the best combination of max load, torsion rigidity and height for any possible application.

The Series number of Gitzo tripods is defined by the diameter of the top leg section. A higher Series number corresponds to better torsional rigidity, higher maximum load capacity and greater height.

the safari range

GITZO

head range



GH1720FQR

series 1.

Series 1 size is an incredibly lightweight and yet exceptionally precise and stable head. The perfect and only match match for the high-performance compact spotting scopes. It sets a new standard in bird watching supports for lightweight, accuracy, speed and comfort. Ultra compact, this head performs at its best when coupled with Gitzo series 1 carbon fibre tripod and with the innovative Bird Watching Traveler kit



GH1780FQR

series 1.

This series 1 head is a little jewel of engineering well representing Gitzo tradition and approach. A beautiful high performance head, designed to achieve a rock solid locking without compromising on control smoothness and comfort. Its extremely small size and lightweight coupled to a 10 kg max load, makes this head the ideal companion for long relaxing outdoor walks without compromising on image quality. Recommended for equipment up to 200 mm lens, it can safely hold larger equipment.



GH2720FQR

series 2.

Series 2 size offer the same level of quality and technology of the smaller series 1 with an even higher level of performance and stability. In this size Gitzo design guarantees a degree of accuracy, smoothness and stability never experienced before, becoming an indispensable support for the serious bird watcher. This head is also recommended for HD video applications with the latest generation of DSLRV cameras.w



GH2780FQR

series 2.

Series 2 size brings the quality and performance of the smaller version to a higher level. Its main advantage over the series 1, a part from a higher pay load (that in any case is already more than enough in the series 1 size), is a higher level of control and smoothness, thanks to the larger sphere. This is especially appreciated when some more friction in the movement is required, especially with longer and heavier equipment. Recommended for equipment up to 300 mm lens, it can safely hold larger equipment.

tripod range



GT1540F

series 1.

Offers an excellent maximum load capacity and good torsion rigidity at a reduced weight. Series 1 is the ideal solution when space and weight are key factors.



GK2520FT

bird watching traveler kit

series 2.

Extremely lightweight and compact, this kit is the ultimate solution for bird watchers looking for a regular size tripod that combines lightweight, compactness and transportability.



GT2540F

series 2.

Excellent maximum load capacity and great torsion rigidity, available in 3- and 4-section models at standard and eye level heights. Series 2 is the ideal solution: a solid tripod without sacrificing weight.

GT2540FL

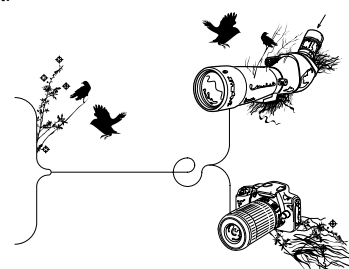



safari heads



two ways fluid heads bird watching

series available

1. 2.



With the introduction of these new 2 way Bird Watching heads, Gitzo continues its tradition in inventing unique high performance solutions, highly specialized by application. Bird Watching is a special experience, with completely different requirements from video and photo applications. In spite of this, all the heads used by bird watchers are actually developed for video and photo equipment. As a result Bird Watchers use larger, heavier and more complicated supports than they need.

Gitzo heads instead have been developed with one thing only in mind: make them the only and first ever 100% Bird Watching head. Such an approach allowed to develop a non-conventional project, for ultra stable and precise observations, that perfectly matches carbon fibre Gitzo tripods, generating an extraordinary combination for performance and portability.

Key innovations of these heads are the new Bird Watching Fluid Cartridges, the Single Lock System and the ultra-precise inner mechanism.

Pan and Tilt fluid cartridges are completely new and offer a completely opposite behaviour than the traditional video ones. These innovative cartridges guarantee an ultra smooth and controlled movement at very low speed (exactly what Bird Watchers are

looking for), while at high speed the movements become almost completely free, and this is very useful when a fast equipment repositioning is required. This behaviour is clearly visible in the below chart.

These cartridges are also very small and compact, allowing for a slim and lightweight design.

Single lock is the other specific innovation for bird watching. Pan and Tilt movements are locked and frictioned in parallel by a single large knob, making head control simple, fast and effective as never before.

All inner mechanisms are tuned to achieve the maximum precision and eliminate even the smallest gives and plays. Stability, precision and structure stiffness are the most immediate advantage of these beautiful heads for making the best out of your high performance equipment.

Thanks to the ultra smooth and precise movement and the high pay load, these heads are also an interesting support for HD hybrid DSLR's cameras, for smooth and controlled video shooting.

Gitzo bird watching heads feature a reversible pan bar for left and right handed users. Pan bar can also be removed and substituted with an elegant end cup.

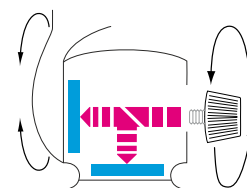

single lock

■ pan & tilt locks
■ twin mechanical control

Single lock is the other specific innovation for bird watching. Pan and Tilt movements are locked and frictioned in parallel by a single large knob, making head control simple, fast and effective as never before.

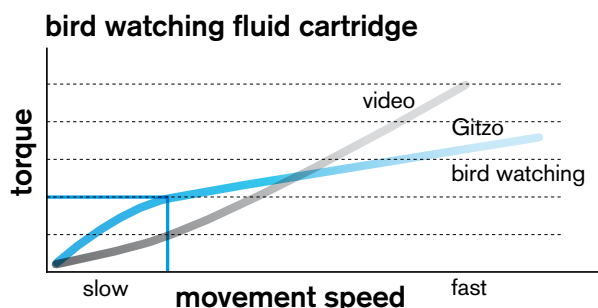

Gitzo bird watching heads feature a pan bar, fully adjustable at any angle and reversible for left and right handed users. The heads can also be used without the pan bar for additional compactness and easier transportability in the wild. In this case pan bar support is replaced by an elegant end cup.

for more information see the back of the cover

safe grip

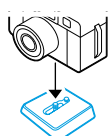

double quick release safety system

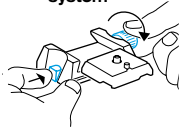

bird watching fluid cartridge

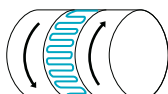

reversible handless

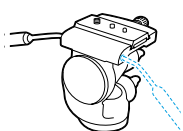

single lock

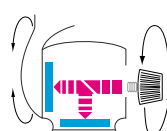





Also available in noire décor color.
GH1720QR and GH2720QR

recommended
"arca style" plate adapter GS5160CDT



series	ref.			QR	plate type	pan	tilt	pan and tilt single lock			
1.	GH1720FQR	•	•	•	quick release with 1/4" screw	360°	+110°	•	9,2 cm/3.6"	0,46 kg/1.01 lbs	4 kg/8.82 lbs 10 kg/22.04 lbs
2.	GH2720FQR	•	•	•	quick release with 1/4" + 3/8" screw	360°	+110°	•	10,7 cm/4.2"	0,7 kg/1.54 lbs	6 kg/13.22 lbs 15 kg/37,05 lbs

* The higher pay load is measured accordingly to competitors' standard, directly on the head attachment screw. This method leads to a max pay load 2,5 times higher than Gitzo standard that is more severe and uses a 12cm/4.7" lever to simulate equipment center of gravity.

center ball heads photo

series available

1. 2.



Gitzo is renowned for its beautiful range of high performance tripods that represent the state of the art of the market. Now Gitzo launches a completely new and innovative range of center ball heads, engineered to be the perfect match to our tripods. These heads are designed to be an extremely balanced product, that not only guarantee a high max load, but that also maximize other key features, too often overlooked by the end users. These features include smoothness, minimized drift angle, lightweight, low gravity center, greater tilt angles, compactness, ergonomics and safety. This is achieved by means of unique and exclusive technical solutions, such as the hollow Bubble Ball, the Spring Assisted Double Lock (SADL) and the new leveling system. The Bubble Ball allows for an impressive weight reduction and it gives these heads the best weight to max load ratio in the market. The revolutionary SADL system combined to the PTFE treated

Bubble Ball guarantees both an exceptional locking power and ultra smooth high precision movement.

The new leveling system made of three independent leveling bubbles on the quick release plate and one in the ball stem, always guarantee perfectly leveled images.

The problem that affects many high quality heads in the market regarding the drift angle is absolutely minimized with an outstanding value of 0,03°.

The quick release plate, besides the traditional double safety system, features a new lever operated locking for increased safety and compactness. The new Gitzo ball heads include a convenient Anti Dust Bag for storage and packing. The textile anti dust bag is also a support to environmental protection; aiming to reduce the amount of plastic bags the world industry produces every year.

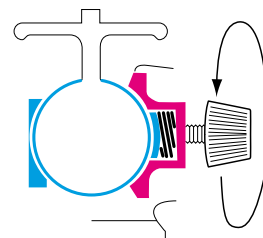

spring assisted double lock

- metal plate
- teflon bushings
- mechanical control

The new center SADL (Spring Assisted Double Lock) is a patent pending system that combines two locking systems in one, maximizing both locking power and ball smoothness.

A high friction metal guarantees a high efficiency lock, the PTFE bushing controlled by a pre-loaded spring maximizes smoothness and control.

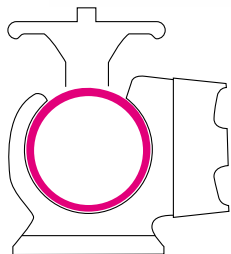

bubble ball

Gitzo Bubble Ball comes from an exclusive technology that enables us to produce high quality, completely round hollow spheres, with a ultra thin wall, for an incredible weight reduction.

The Gitzo Bubble Ball not only guarantees a dramatic weight reduction, but it also allows us to increase the size of the ball for each series, with great improvements in the locking performance and in the smoothness of the movement.

Gitzo Bubble Ball also features a perfected PTFE treatment that further reduces the surface micro roughness for the ultimate shooting experience and accuracy.



Also available in noire décor color. GH1780QR and GH2780QR

for more information see the back cover fold-out

bubble ball

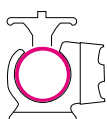

spring assisted double lock

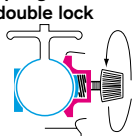

leveling bubble

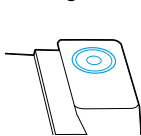

safe grip

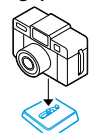

separate pan control

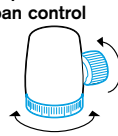



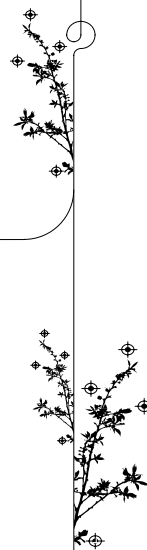
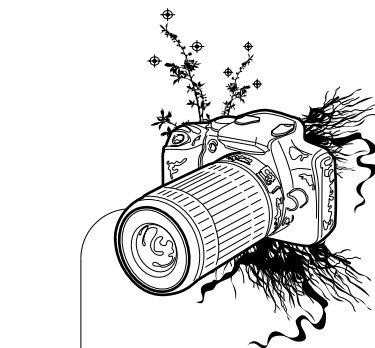

double quick release safety system





recommended
"arca style" plate adapter [GS5160CDT](#)



series	ref.			QR	plate type	pan	tilt	pan locking	ball locking			
1.	GH1780FQR	•	•	•	quick release with 1/4" screw	360°	+95°/-13°	•	•	9,5 cm/3.74"	0,35 kg/0.77 lbs	10 kg/22 lbs 25 kg/55 lbs
2.	GH2780FQR	•	•	•	quick release with 1/4" screw	360°	+100°/-18°	•	•	9,6 cm/3.78"	0,43 kg/0.95 lbs	14 kg/30.8 lbs 35 kg/77 lbs

* The higher pay load is measured accordingly to competitors' standard, directly on the head attachment screw. This method leads to a max pay load 2,5 times higher than Gitzo standard that is more severe and uses a 12cm/4.7" lever to simulate equipment center of gravity.



safari tripods



mountaineer tripods photo & bird watching

series available

1 2.



When Gitzo launched the Mountaineer tripods in 1994, they were the World's first carbon fibre tripods. Ever since then they've set the standard for performance and quality. The main feature of the range is the 6X carbon fibre tube, made of a unique structure of 6 crossed layers that maximises rigidity, vibration, absorption and lightweight performance- ideal qualities for nature photography and bird watching

The 6X tube has a high density structure, 100% made of top quality ultra-thin carbon fibres (7µm or 0.007 mm). Built-in Anti Leg Rotation is now a feature of the whole carbon fibre range. Mountaineer tripods have been consistently improved with features and details that increase performance, versatility and quality. The G-Lock is our leg locking system that increases system rigidity by 20% and allows quicker and stronger leg locking. We've also added a solid machined aluminium upper disc with locking screws and a new Safe Lock

material that reduces vibration and improves grip between the tripod and head. The upper disc can also be fitted directly to the upper casting, removing the centre column for ground level photography or to save weight. New tripods also feature an additional third leg spread angle for an ultra-low position that allows you to take full advantage of the "Ground Level Set".

Safari Mountaineer tripods are specifically configured for outdoor with special features, like factory pre-installed spiked feet for mud, ice and snow, and the latest development- the exclusive waterproof Ocean-Lock. Besides the Ocean-Lock, all internal components are designed to withstand water and extreme climates. All these special features, added to the fact that Gitzo tripods are the only ones that meet military standards, make Safari Tripods the ideal outdoor tool- ready for everything. All new Mountaineer tripods come with a convenient anti-dust bag for storage and packing.

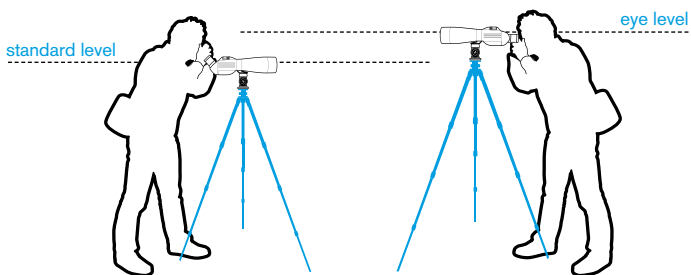
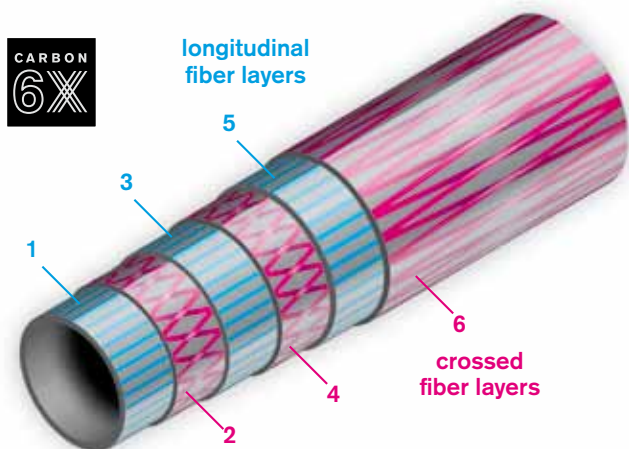

standard-chest level tripod
series 1 & 2.

long-eye level tripod
series 2.

Gitzo tripods are available in different heights. This is particularly useful for nature photography and Bird Watching, where the user height and the kind of equipment used is considered. For example, in the case where a straight scope is used, generally a long eye level tripod is preferred, while for angled scopes, a standard height tripod usually is the right choice.

Gitzo 6X is the most advanced carbon fiber tube in the market and guarantees structural strength, flexion rigidity and great vibration absorption properties.

Gitzo 6X is the most advanced carbon fiber tube in the market and guarantees structural strength, flexion rigidity and great vibration absorption properties.

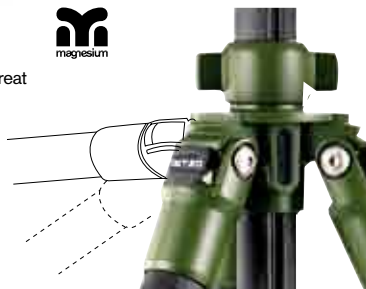

Series 1, 2 and 3 Mountaineer tripods now feature a new third leg spread that allows you to go very close to the ground. This third leg position allows you to take full advantage of the Ground Level Set. Series 2 tripods upper casting is now made of Magnesium. It has been completely redesigned for increased torsion rigidity.

The upper disc is totally new. It is made of machined aluminum, with an insert in our new Safe Lock material. Series 2 and 3 tripods now come with the new aluminum Power Disc for a more secure locking of the head thanks to the additional locking screw. All discs can be mounted directly to the tripod top casting (Ground Level Set feature). The 1/4"-3/8" reversible screw has been redesigned for more reliable functionality.

material weight comparison

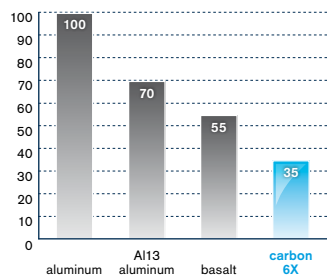

Carbon 6X high density 1mm tube is 30% lighter than the former 1.5mm tube. Thanks to the new 6X crossed layer construction, it offers superior performance in terms of rigidity and vibration absorption.

for more information see the back cover fold-out

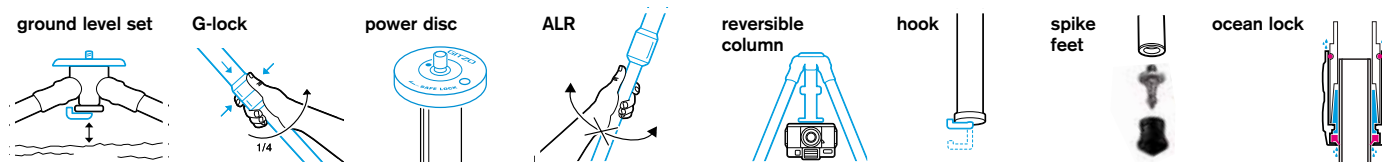

series

1.



Recommended for compact cameras, lightweight camcorders and DSLRs with 75mm lens or 135mm maximum. Given its small size and extremely light weight, this tripod offers an interesting compact solution for the latest generation of small scale digital equipment. The G-Lock system and improved tube structure give good performance in terms of torsional rigidity.

series

2.



An excellent choice for MiniDV, compact digital cameras and DSLRs with 135mm lenses, up to a maximum of 200mm. Offers an excellent maximum load capacity and good torsion rigidity at a reduced weight. Available at standard height. Series 1 is the ideal solution for photographers on the move or when space and weight are key factors. All series 1 tripods (geared version excluded) now feature a new third ultra low leg spread for ultra low ground position to take full advantage of the Ground Level Set.

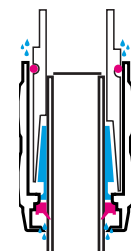

Ocean-Lock is a perfected G-Lock system that, thanks to special inserts at both ends, minimises the amount of water and debris that may enter tubes and treads. The upper Stainless Steel leg ends are provided with a special funnel-like hole that allows to empty the small amount of water that may have entered the tubes.

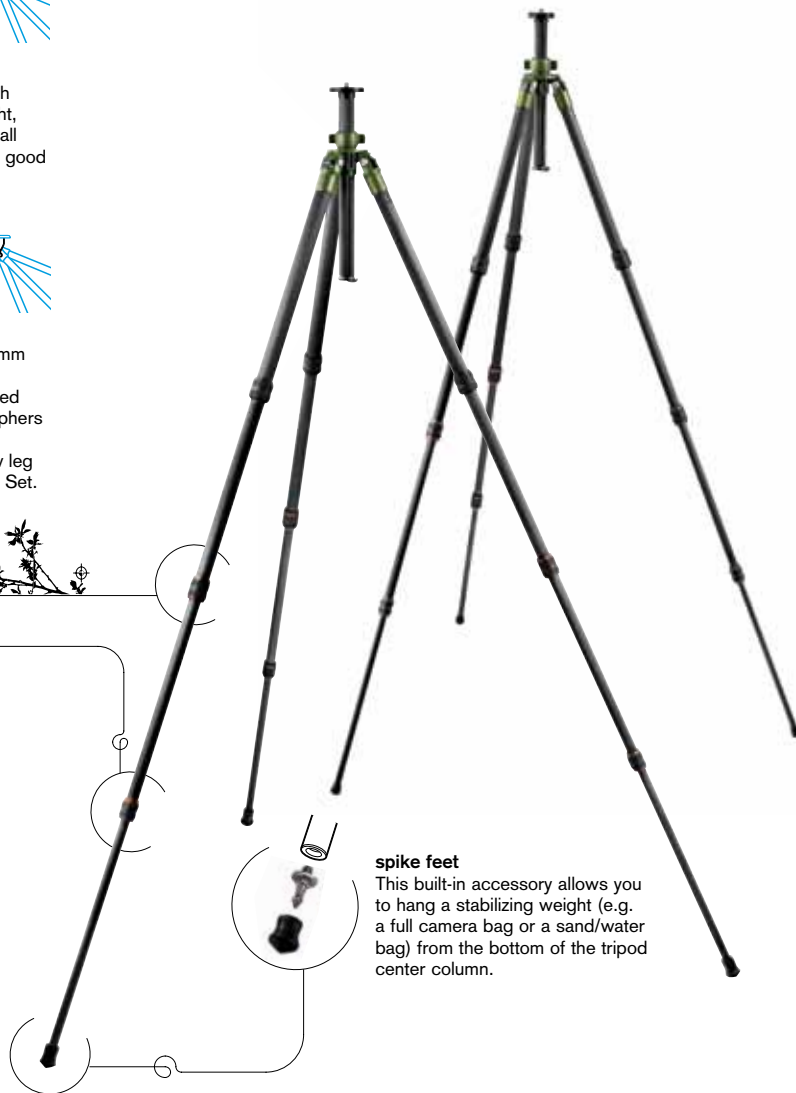







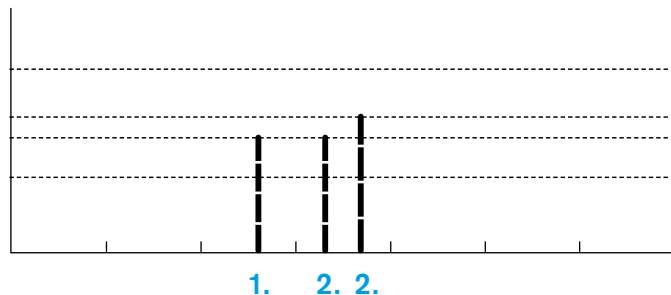

slope feet

This built-in accessory allows you to hang a stabilizing weight (e.g. a full camera bag or a sand/water bag) from the bottom of the tripod center column.

height comparison



series	ref.		ALR	G-lock & Ocean lock								
1.	GT1540F	•	•	•	rapid	4	159 cm/62.6"	138 cm/54.3"	17 cm/6.7"	54 cm/21.3"	1,12 kg/2.5 lbs	8 kg/17.6 lbs
2.	GT2540F	•	•	•	rapid	4	153 cm/60.2"	130 cm/51.2"	17 cm/6.7"	55.5 cm/21.9"	1,36 kg/3 lbs	12 kg/26.4 lbs
2.	GT2540FL	•	•	•	rapid	4	175 cm/68.9"	151 cm/59.4"	17 cm/6.7"	61 cm/24"	1,43 kg/3.1 lbs	12 kg/26.4 lbs

bird watching kit safari traveler

series available

2.



Traveler is a unique concept invented by Gitzo that has become a must for compact photo supports. The revolutionary system comes from the intuition of folding the legs upside down in order to minimize the support folded length during transportation. The new Safari Traveler kit combines for the first time all of the desires of the keen bird watcher. It maximises extreme light weight, compactness, stable and vibration free performance, controlled and precise scope movements with a full size tall tripod for comfortable and long lasting observations. Following Gitzo tradition, even the smallest detail has been taken care of in order to make the Safari Traveler Kit the ultimate tool for Bird Watching.

The best Gitzo materials and technologies like the carbon fibre 6X tubes and the ultra-light weight yet extremely sturdy design are matched with outdoor specific features.

A special combination is used for leg locks: the upper lock is the powerful G-Lock that guarantees extremely high performance with a smooth and fast action, ideal to level the tripod on uneven surfaces. The two lower locks are the exclusive Ocean-Locks, a special waterproof version of G-Lock that allows you to plunge the tripod into water and mud with no risk of damaging it. All inner components are design to withstand water and humidity. This kit includes pre-installed spike feet with a special rubber cover for

increased versatility and efficiency in every outdoor environment.

The series 2- tall, strong and yet lightweight tripod has been chosen to guarantee the most stable and ergonomic platform, while a smaller, lighter yet high performance series 1 2way head has been selected in order to maximise compactness and transportability without sacrificing stability and movement control. This new head is the only head in the market that is specifically developed for bird watching and is not derived from video applications. The head combines light weight and compactness with the latest Gitzo technologies, and the main body is made of casted lightweight magnesium. The two fluid cartridges are specific for this application and movements are exceptionally smooth and controlled. Furthermore, it features the innovative Single Lock System for a faster, more intuitive and ergonomic operation. In this special kit only the series 1 head comes with a longer quick release sliding plate to improve balancing capabilities even when longer and heavier equipment, like for digiscoping, is used. The new Series 2 Traveler comes with a smart Gitzo display cleaner and a convenient anti-dust bag for packing and transportation. The textile anti-dust bag contributes an answer to environmental protection; aiming to reduce the amount of plastic bags that global industry produces every year.



Every single detail is designed to achieve the maximum compactness without compromising on ergonomics and performance. The project is inspired by a totally new approach that sees the head and tripod as a whole and not as two separate entities.



The new Safari Traveler is the ideal tool for the keen bird watcher. Every single detail has been studied and developed for the outdoors, to guarantee comfortable, high quality, and long observation thanks to its ergonomics, performance, maximum compactness, light weight and precision.

The beautiful design is derived from the limited edition Titanium and Ocean tripod. It has been developed by advanced 3D modelling software to ensure the maximum rigidity of structure with minimum weight.

for more information see the back cover fold-out

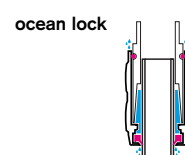
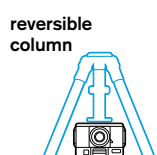
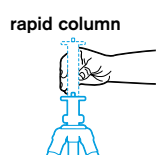
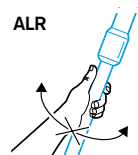
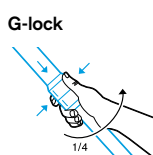
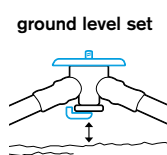

series

2.

Recommended for DSLR with to 200mm lenses up to 300mm maximum, the new Series 2 Traveler offers excellent maximum load capacity and great torsion rigidity thanks to G-Lock and the newly designed upper casting. Extremely lightweight and compact, this kit is the ultimate solution for photographers looking for a regular size tripod that combines lightweight, compactness and transportability without compromising on stability and image sharpness. It is available in the popular four section standard level configuration and includes the new Traveler Series 2 head.

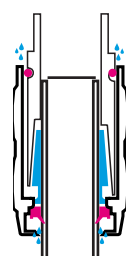

Ocean-Lock is a perfected G-Lock system that, thanks to special inserts at both ends, minimises the amount of water and debris that may enter tubes and treads. The upper Stainless Steel leg ends are provided with a special funnel-like hole that allows to empty the small amount of water that may have entered the tubes.



spike feet

This built-in accessory allows you to hang a stabilizing weight (e.g. a full camera bag or a sand/water bag) from the bottom of the tripod center column.

height comparison

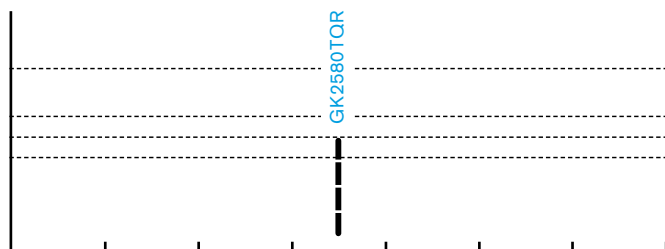

2.



recommended carrying solutions

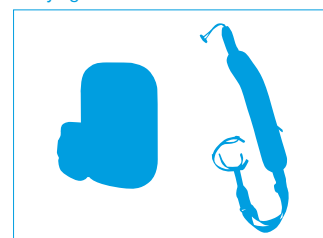

series	ref.		ALR	G-lock								
2. 	GK2540FT	•	•	•	rapid	4	154 cm/60.6"	129.5 cm/51"	32 cm/12.6"	43 cm/16.9"	1,72 kg/3.78 lbs	7 kg/15.4 lbs



accessories & photo gear



tripod accessories

leveling spirit bubble for tripod columns

These leveling spirit bubbles can easily fit at the bottom of the tripod columns. Available for series 1 and 2 tripods, they are compatible with any model and material. They are the same accessory that comes as standard for all Gitzo Leveling tripods. No tools or glue are needed for the installation: just remove the hook assembly, insert the leveling spirit bubble and lock the hook assembly back in position.



GLEVEL1



GLEVEL2

G1539 double platform

G1539 enables cameras (or 2 heads) to be fitted - 35cm apart center to center - to a single tripod column. Suitable for 35mm or medium format cameras.

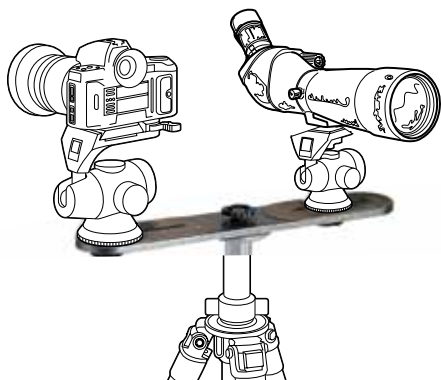

G1220.130B big foot series 2. 3.
G1410.130B big foot series 4. 5.
G1220.130B3 big feet series 2. 3.
G1410.130B3 big feet series 4. 5.



All terrain vibration absorbing foot for mud, snow or sandy surfaces.

For monopods series 2. 3. G1220.130B.

For monopods series 4. 5. G1410.130B.

Set of 3 feet for tripod series 2. 3. G1220.130B3

Set of 3 feet for tripod series 4. 5. G1410.130B3

GS5000C M12 to 3/8" adapter

This convenient small adapter allows the user to mount an additional disc or other tripod accessories in place of the retractile hook assembly at the bottom of the column. It works only for the new generation of tripods that feature the Ground Level Set. In these tripods, the hook assembly is fixed by a M12 thread, and thus this 3/8" adapter is needed in order to attach any other standard accessory. This adapter is not necessary and it would not work for the previous generation of tripods without ground level. These older tripods already have at the bottom of the column a 3/8" thread.



GSGREASE02 tripod grease

Gitzo leg locking systems are designed to serve for a life time and to always perform at their best. In order to help these components to deliver their mission, it is recommended to always use the proper grease every time your tripod is cleaned. Gitzo uses a special product that guarantees a smooth operation and protects the metal surfaces from excessive wearing over time. Furthermore, thanks to its special formula, it is not sticky in order to avoid attracting dust, sand and other dirt that may dramatically reduce the locking system life time. This grease is now available in convenient small tubes sold in a set of two. Each tube is enough to lubricate a four section tripod. We always recommend to use a minimal quantity of grease. An excessive amount may attract undesired dirt and reduce the locking ability of the system.



GS5030VSF photo-video double use spike-rubber feet

These feet are traditionally used in video tripods but they can also be very useful for photographic applications. These feet can be easily transformed into spike or rubber feet by simply turning the rubber cups in or out.

These spike-rubber feet can be easily applied to any tripod provided with removable feet. No adapters or special tools are required.



G1220.129B3 spikes for tripod

Stainless steel spike for monopod

Stainless steel spikes for tripods



G1220.129LB3 XL long spikes for tripod

XL stainless steel long spike for monopod

XL stainless steel spikes for tripods

GS3030 - GS5030 self locking removable rubber feet

These self locking feet, thanks to an additional built in rubber ring, allow for a more secure locking and prevent accidental loss. These self locking feet can not be used on older tripods. Available in two different sizes accordingly to the suitable series, they are compatible with the G-Lock Leg Section Reducers.

Set of 3 feet for tripod series 1. 2. 3. GS3030

Set of 3 feet for tripod series 3. 4. 5. GS5030



GS3030

head accessories

GITZO

quick release plates

Gitzo quick release plates come in three different profiles (A, B and C). Each profile is offered in different lengths (short or square, medium and long) and with different features (graduated, anti rotation pin) and attachments (1/4" - 3/8"). The new GS5370XLC extra long C profile quick release plate is 200 mm long and it is specifically dedicated to wild life, sport and action photography. It allows to finely balance your equipment on the support for a more precise shooting action. It is the ideal complement to the Systematic head GH5380SQR, the Series 3 center ball head GH3780QR and any other Gitzo equipment compatible with C profile QR



plates. The plate includes 2 screws for both 1/4" and 3/8" sizes. In the new collection we unified some 1/4" and 3/8" attachment plates into a unique new code that includes 2 screws for both 1/4" and 3/8" sizes. Having two screws available for each attachment size is ideal, above all for long plates, when heavy equipment or long lenses are used. As a general rule, it is preferable to always use the bigger possible attachment. In any case, even when the smaller screw needs to be used, it always guarantees a high safety standard. In fact all Gitzo bolts and screws are made of high quality steel.

ref.	QR plate type	attachment	size style	size (w - l) mm/ inc					
					center ball heads	fluid heads	traveler kit		
					GH1780FQR	GH2780FQR	GH1720FQR	GH2720FQR	GK2540FT
G2285M/14*	C	1/4"	square	38x38 1,50x1,50	std	std	std	•	•
G2285M/38*	C	3/8"	square	38x38 1,50x1,50	•	•	•	•	•
GS5370C*	C	1/4"	square	38x38 1,50x1,50	•	•	•	•	•
G2382B*	C	1/4"	medium	38x82 1,5x3,23	•	•	•	•	•
GS5370MC*	C	3/8"	medium	38x82 1,5x3,23	•	•	•	std	std
G1382L/14B*	C	1/4"	long graduated	38x140 1,50x5,51	•	•	•	•	•
G1382L/38B*	C	3/8"	long graduated	38x140 1,50x5,51	•	•	•	•	•
GS5370LC*	C	2x1/4"	long graduated	38x140 1,5x5,51	•	•	•	•	•
GS5370XLC*	C	2x3/8"	long	38x200 1,5x7,87	•	•	•	•	•

* Supplied with anti rotation VHS pin

GS5160CDT

"arca style" quick release plate adapter

This adapter is a smart solution that fits standard "arca style" quick release plates on standard Gitzo quick release adapters.

It works on a simple principle. It has to be inserted into a Gitzo profile C quick release adapter (please refer to the enclosed compatibility chart) and it safely locks into position, thanks to the Gitzo safety system. Now your head is ready to accept a standard "arca style" quick release plate. In order to lock the "arca style" plate into position, just use the standard locking knob or lever. The Gitzo adapter inner part is created to act like a spring and to solidly lock your plate into position.

The GS5160CDT adapter is made of high quality machined aluminum and features the new perfected PTFE surface treatment that guarantees maximum smoothness and does not scratch quick release plates.

Important Note: Arca style plates can have different width measurements depending on brand and specific model.

The Gitzo adapter is compatible with the "arca style" plate within a specific range of width and it does not cover all the possible widths available in the market.

For this reason we recommend before purchasing, to always check the compatibility of the Gitzo adapter with the specific quick release plate you are going to use.

It is very difficult to precisely measure the width of the "slopes" of these quick release plates, and even tiny differences can create very different results.

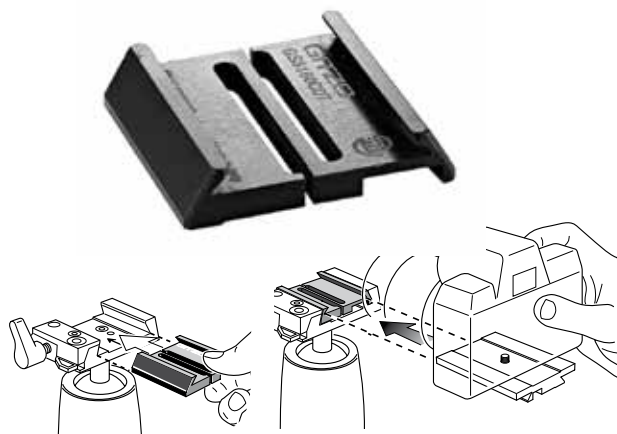

ref.					
	center ball heads	fluid heads	traveler kit		
	GH1780FQR	GH2780FQR	GH1720FQR	GH2720FQR	GK2540FT
GS5160CDT	•	•	•	•	•

accessories
& photo gear

apparel four season jacket



The Four Season Jacket is the first fully waterproof jacket specifically designed for professional photographers. Following its mission of developing professional photo essentials, Gitzo provides the ultimate and only solution to pro photographers who are looking for maximum protection from rain and wind without compromising with storage and accessibility of their equipment. The jacket has been developed with the support of pro photographers and includes in its structure all their advices and experience. It is intended to be used in different environments, such as sport events, concerts, downtown and also in naturalistic activities. The construction and materials used are the best ones the technical clothing industry can offer, like sealed seams, Teflon treated nylon, Cordura and Ecodry membrane. The result is a perfectly waterproof jacket, comfortable, highly durable and most importantly fully breathable. For this reason it can be suitable for various temperature all around the year and for photography on the move. A full set of inner and outer pockets is one of the main advantages of this apparel, especially the two main pockets on the front. These pockets are completely water proof and can be expanded, together with the protective top flap, by means of lateral zips in order to fit even larger equipment. They feature removable padding and a

special elasticized band to vertically support your lenses. Other pockets are intended for many other essentials, like flashlights, batteries, filters, cables, memory cards, binoculars and so on. Also included inside is an organizer style pocket, for business cards, pens and note book. A big waterproof pocket on the back gives room to several larger items, like a bottle of water. Another unique feature of this jacket is the "Light Shield" incorporated in the hood, with the dual function of protecting from the rain but above all to shield the light off the camera display improving the LCD visibility. The long waterproof zippers that run on both sides are also very convenient for additional ventilation (also enhanced by the ventilation ports on the back) and to access the inner pockets in windy and rainy conditions. These zippers, when fully opened from the bottom, also allow for extra movement and for having the two main pockets in front of us when kneeling down. Both shoulders and elbows are padded in order to give good protection. When safety and visibility are key factors, the jackets can be fitted with a special high visibility kit. This kit consists of a large panel for the back and two smaller ones for the chest, Velcro attachable. The right front panel embeds a pass holder. The high visibility kit is available separately as an add-on kit (GHV100-PRESS).

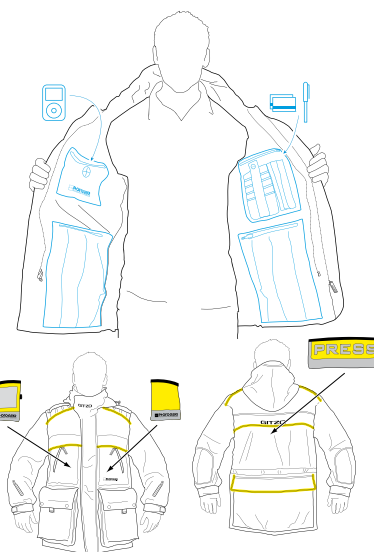

The two long waterproof zippers on the sides allow for additional movement, provide ventilation and access to the inner pockets.

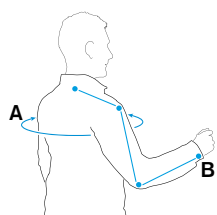

ref.		GA151S	GA151M	GA151L	GA151XL	GA151XXL
size		S	M	L	XL	XXL
A	cm	89-93	94-99	100-105	106-111	114-119
	inches	35-36,6	37-39	40-41	42-44	45-47
B	cm	80-82	83-85	86-88	89-91	92-94
	inches	31,5-32,5	32-33	34-35	35-36	36-37

The jackets can be fitted with a special high visibility kit that consists of a large panel for the back and two smaller ones for the chest, Velcro attachable. The right front panel embeds a pass holder. The high visibility kit is available separately as an add-on kit (GHV100-PRESS).

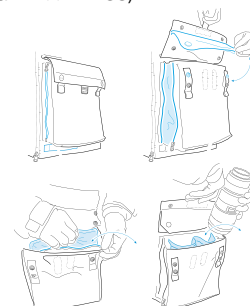

The two main front pockets are waterproof and can be expanded in order to fit larger equipment. They feature removable padding and an elasticized lens holder.

apparel fleece jacket



The Fleece Jacket is the first one specifically designed for professional photographers. Following its mission of developing professional photo essentials, Gitzo provides the ultimate and only solution to pro photographers who are looking for maximum protection from wind and cold without compromising storage and accessibility of their equipment. The jacket has been developed with the support of pro photographers and includes in its structure all their advice and experience. It can be either a good alternative to the four-season jacket in the winter season or it can be attached to the jacket in order to have a "winterized", totally waterproof and highly technical product. The materials used are Teflon treated nylon, Cordura, Ecodry and Zero Wind membrane. The mix of these materials allows the jacket to be windproof, highly breathable and highly durable. There's a set of external pockets that can enable the photographer to have everything at

hand. The two main ones have extractable padding. They are adjustable in size thanks to two side zippers and are tailored to the size of lenses, flashlights and such items. Two additional smaller pockets on the chest are intended to hold smaller items and include a pass holder. A double pocket on the back of the jacket can be used for several items, including a Traveler tripod or a bottle of water. There's also a whole set of inner pockets that can carry business cards, pens, other small or valuable accessories. There are also two cargo inner pockets, which have room for bigger items such as binoculars, flashlights and similar items. The shoulders and elbows are padded in order to protect the photographer. There's also a snap hook and several loops that can be used to temporarily attach different belongings, from a monopod to any other item.

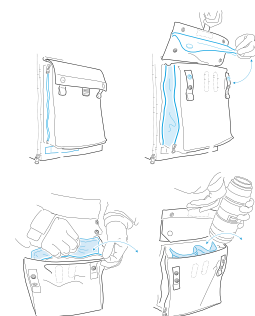
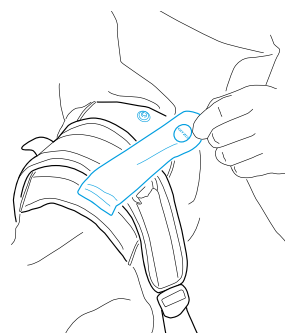
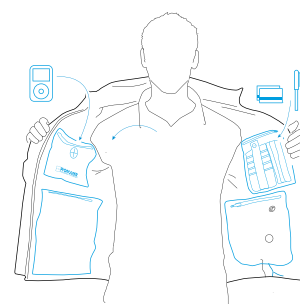

The shoulders are padded for additional comfort and feature a special loop to secure any shoulder strap.

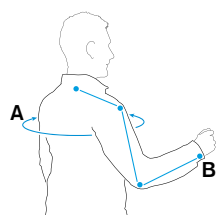

ref.		GA140S	GA140M	GA140L	GA140XL	GA140XXL
size		S	M	L	XL	XXL
A	cm	89-93	94-99	100-105	106-111	114-119
	inches	35-36,6	37-39	40-41	42-44	45-47
B	cm	80-82	83-85	86-88	89-91	92-94
	inches	31,5-32,5	32-33	34-35	35-36	36-37

The two main front pockets are waterproof and can be expanded in order to fit larger equipment. They feature removable padding and an elasticized lens holder.

The holsters provide a totally new and revolutionary way of transporting your tripods and monopods. It is a smart, comfortable, lightweight and very quick-to-use carrying solution. The system is intended to be operated with one hand only and to hold your equipment safely in place. The paddle on the back is a high quality patented one that guarantees a perfect and strong connection to your belt in any

condition of use. The top part is rubberized to maximize the grip and hold the equipment more safely. An ideal complement to our Traveler range, thanks to the adjustable strap, it is also suitable for several sizes of tripods and monopods. Another unique feature is a convenient anchoring point that allows you to steadily support your equipment directly on your body.



The GC3320, ideal for the traveler tripods, is also intended for several sizes of tripods from the Gitzo range.

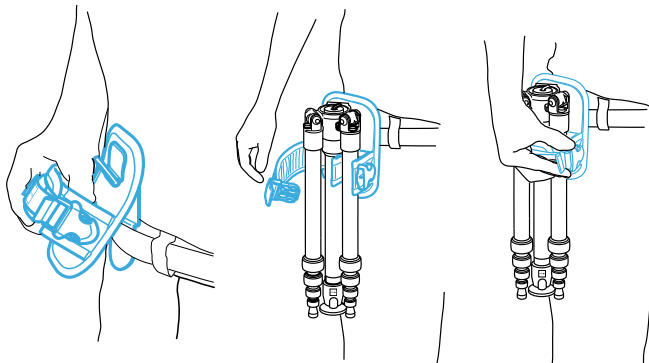

The system is intended to be operated with one hand only and to hold your equipment safely in place.

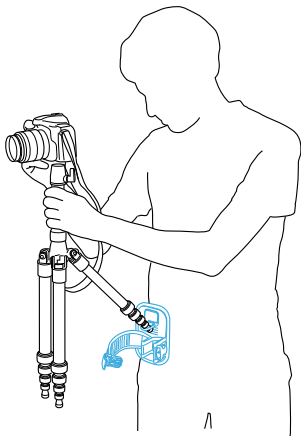

They are equipped with a convenient anchoring point that allows you to steadily support your equipment directly on your body, also on the move and without opening the legs completely.

series	ref.	intended use								
		traveler	leveling	series						
				00	0	1	2	3	4	5
0. 3.	GC3320	•	•		•	•	•	•		

tripod strap

compatible series 0. 1. 2. 3.

GITZO

The Gitzo strap is a clever and “quick-to-use” carrying solution specifically developed to serve most of Gitzo tripods. Ideal for situations in which the timeframe for a snapshot is short and the time for packing and unpacking the tripod is even less. The strap is adjustable to fit tripods of different sizes and can be left on the tripod while shooting. The connection system is specifically developed to fit old and new

Gitzo tripods without compromising on functionality and safety. An additional neoprene pocket is ideal to hold tripod accessories, mobile phones or other small items. The materials used are neoprene and rubberized textile. The comfort of the shoulder strap is enhanced by thick neoprene and a thermoformed structure for additional ventilation.

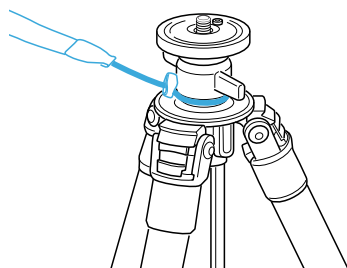

The upper part of the strap anchors the tripod just below the column-locking collar. This safe and easy solution allows you to retro fit all Gitzo tripods, old and new, without compromising on functionality and safety.

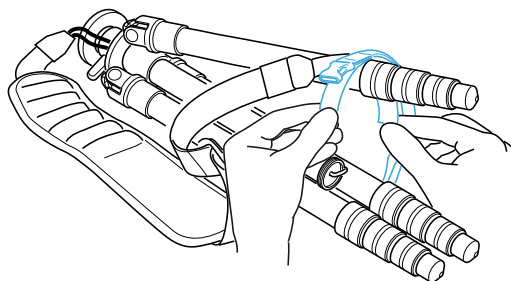

The lower part connects to the tripod by means of a double loop. One loop is permanently attached. The second bigger loop secures all three legs together during transportation. Both loops are adjustable to fit tripods from series 0 to 5.

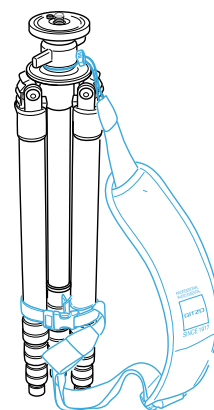

The strap perfectly fits any old and new Gitzo tripod. The smart connection system allows for a quick and reliable operation in location and during transportation.

series	ref.	intended uses by series						
		traveler	leveling	explorer	mountaineer	basalt	aluminum	systematic
0. - 3.	GC5210	•	•	•	•	•	•	

leg warmers

series available 1. 2. 3. 4. 5.

leg warmers

Leg warmers are recommended to increase the level of protection and comfort while using and carrying tripods. These new Gitzo leg warmers combine the two things, without compromising on lightweight and compactness, so appreciated on Gitzo tripods. They are protective enough for the legs and, at the same time, they have a very soft touch that makes them really pleasant to use. They are made of a soft coating on the outside and feature a special non-slip rubber on the inside, for added stability and safer handling. Once you're used to them, you won't be able to live without them!. These leg warmers come in a set of three and are available in two versions: GC2560 dedicated to Series 1 and 2 tripods, and GC5560 for Series 3, 4 and 5.

series	ref.	intended uses by series				
		1	2	3	4	5
1-2 <small>new</small>	GC2560	•	•			
2-5 <small>new</small>	GC5560			•	•	•



safari leg warmers

Gitzo introduces a special configuration of leg warmers: the Safari leg warmers are specifically studied on the outdoor use and environment, typically wild life photographers and bird watchers. First of all they guarantee great comfort while carrying heavier outdoor equipment, such as long lenses, together with a good scratch resistance and camouflage characteristics. The inner padding is provided by a high density closed cell foam. The special construction also makes this padding removable. The outside of the Safari leg warmers is made of a four color camouflage highly durable nylon, while the inside features a special non-slip rubber, for added stability and safer handling. These leg warmers come in a set of three and are available in two versions: GC2160F dedicated to Series 1 and 2 tripods, and GC5160F for Series 3, 4 and 5.

series	ref.	intended uses by series				
		1	2	3	4	5
1-2 <small>new</small>	GC2160F	•	•			
3-5 <small>new</small>	GC5160F			•	•	•





easy bags

These light duty bags are mainly intended to protect Gitzo products from dust, scratches and as a convenient solution for storage and packing and carrying. They can also be used for many other applications and equipments, such as cameras, lenses, flashes, batteries, maintenance tools, spare parts and other essential accessories.

Made of lightweight textile and consistent with Gitzo image, they are available in three different sizes. From a carrying standpoint, such bags are equipped with double strings in order to use them also as a simplified and light weight backpack. A smart folding system allows to reduce the bag into a compact and convenient size.



ref.	size	intended use				
		tripods	monopods	booms	heads	accessories
 GC55X19A0	55x19cm/21.7x7.5"	•	•			
 GC65X19A0	65x19cm/25.6x7.5"	•	•			
 GC75X19A0	75x19cm/29.5x7.5"	•	•			

safari photo shooting





date

location

subject

date

location

subject

date

location

subject

date





location

subject





product summary chart

heads

two ways fluid heads

series	ref.			QR	plate type	pan	tilt	pan and tilt single lock			
1.	GH1720FQR	•	•	•	quick release with 1/4" screw	360°	+110°	•	9,2 cm/3.6"	0,46 kg/1.01 lbs	4 kg/8.82 lbs 10 kg/22.04 lbs
2.	GH2720FQR	•	•	•	quick release with 1/4" + 3/8" screw	360°	+110°	•	10,7 cm/4.2"	0,7 kg/1.54 lbs	6 kg/13.22 lbs 15 kg/37,05 lbs

center ball

series	ref.			QR	plate type	pan	tilt	pan locking	ball locking			
1.	GH1780FQR	•	•	•	quick release with 1/4" screw	360°	+95°/-13°	•	•	9,5 cm/3.74"	0,35 kg/0.77 lbs	10 kg/22 lbs 25 kg/55 lbs
2.	GH2780FQR	•	•	•	quick release with 1/4" screw	360°	+100°/-18°	•	•	9,6 cm/3.78"	0,43 kg/0.95 lbs	14 kg/30.8 lbs 35 kg/77 lbs









index

ref.	model	page
G1220.129B3	Spikes for tripod	28
G1220.129LB	XL long spike for monopod	28
G1220.129LB3	XL long spikes for tripod	28
G1220.130B3	Big feet	28
G1373/14B	Quick release short plate	28
G1410.130B	Big foot	28
G1410.130B3	Big feet	28
G1539	Double platform	29
GA151L	Four season jacket large	30
GA151M	Four season jacket medium	30
GA151S	Four season jacket small	30
GA151XL	Four season jacket extra large	30
GA151XXL	Four season jacket double extra large	30
GC2160F	Safari leg warmers	34
GC2560	Leg warmers	34
GC3320	Holster	32
GC5210	Tripod strap	33







ref.	model	page
GC55X19A0	Easy Bag	35
GC65X19A0	Easy Bag	35
GC75X19A0	Easy Bag	35
GH1720FQR	Two ways fluid head	16
GH1780FQR	center ball head	18
GKT2540FT	Bird watching kit	24
GLEVEL1	Leveling spirit bubble	28
GLEVEL2	Leveling spirit bubble	28
GS3030	Self locking removable rubber feet	28
GS5000C	M12 to 3/8" adapter	28
GS5160CDT	"Arca style" quick release plate adapter	29
GS5370C	Quick release square plate	29
GS5370LC	Quick release long graduated plate	29
GS5370MC	Quick release medium plate	29
GSGREASE02	Tripod-head grease	29
GT1540F	Mountaineer tripod	22
GT2540F	Mountaineer tripod	22
GT2540FL	Mountaineer tripod	22

tripods

mountaineer tripods

series	ref.		ALR	G-lock & Ocean lock								
1.	GT1540F	•	•	•	rapid	4	159 cm/6	138 cm/54.3"	17 cm/6.7"	54 cm/21.3"	1,12 kg/2.5 lbs	8 kg/17.6 lbs
2.	GT2540F	•	•	•	rapid	4	153 cm/60.2"	130 cm/51.2"	17 cm/6.7"	55.5 cm/21.9"	1,36 kg/3 lbs	12 kg/26.4 lbs
2.	GT2540FL	•	•	•	rapid	4	175 cm/68.9"	151 cm/59.4"	17 cm/6.7"	61 cm/24"	1,43 kg/3.1 lbs	12 kg/26.4 lbs

bird watching traveler kit

series	ref.		ALR	G-lock								
2.	GK2540FT	•	•	•	rapid	4	154 cm/60.6"	129,5 cm/51"	32 cm/12.6"	43 cm/16.9"	1,72 kg/3.78 lbs	7 kg/15.4 lbs

spare parts & coding system

Spare parts for Gitzo products are available for years... we can often still repair tripods that are as much as 25 years old. All products keep the same traditional tube diameters and many

parts are built to be backwards-compatible with older ones. On www.gitzo.com you can find exploded views of Gitzo products with spare parts reference numbers.

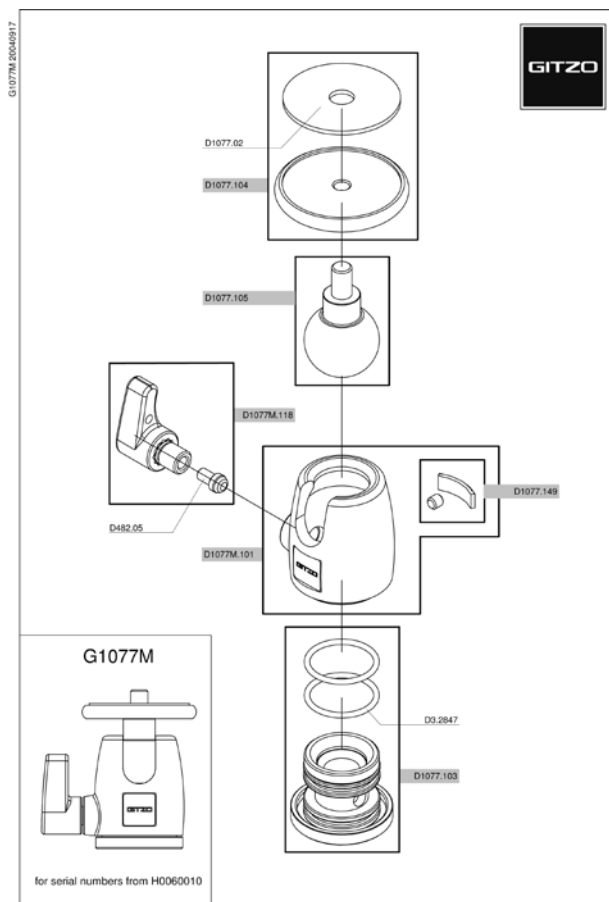
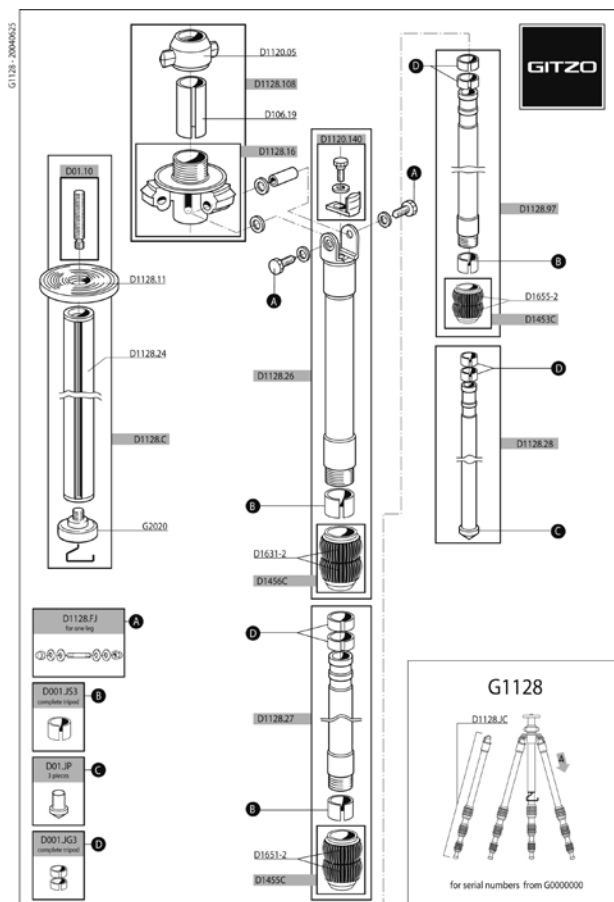

families	materials	release
C carrying sol.	5 carbon 6x	0
H head	7 magnesium	1
K kit		2
T tripod		3

series	leg section	extension	
- 00	3 3	EX explorer	C compact
0 0	4 4	LVL leveling	L long
1 1	5 5	O ocean	XL extra long
2 2	head type	S systematic	QR quick release
3 3	2 2 ways	T traveler	
4 4	3 3 ways	V vintage	
5 5	5 off center	F safari	
	8 center ball		

self explanatory product coding system

In order to make our new products and range easier to understand, Gitzo has renewed the product coding system. The new coding system is based on letters and digits that describe the product characteristics. Thanks to this self-explanatory coding system it is very easy to identify the product and the different versions released. Products are described taking into account the category, the material used, the main characteristics (like number of sections and head type) and other aspects, like height, accessories, special series and other useful information.

While the coding system is probably easier to interpret for main products like tripods, monopods and heads, it is more difficult for the accessories, even if it follows the same logic scheme for all products.

All codes that begin with two letters follow the new self-explanatory scheme. Other codes that begin with one letter only follow the old code. All future new products will follow the new coding system.

tripod and head features

tripod features

ALR

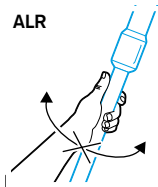

ALR

We have introduced a new Anti Leg Rotation System that allows for ultra fast and smooth operation. Thanks to this new system, it is possible to operate all the locks at the same time and then the sections in a single move. With the new ALR it is possible to open a 5-section Traveler tripod in less than 15 seconds.

rapid column

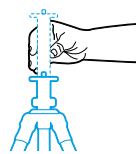

rapid column

The center column locking collar above the tripod shoulder makes it easier to adjust the column quickly. Series 1 and above are built with an anti-rotation grooved center column for improved stability.

reversible column

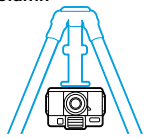

reversible column

The rapid column can easily be inverted for an alternative shooting angle or low level macro work.

hook

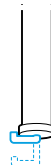

hook

This built-in accessory allows you to hang a stabilizing weight (e.g. a full camera bag or a sand/water bag) from the bottom of the tripod center column. Useful with long heavy lenses, on uneven ground or in windy conditions. The hook can hold up to 18kg (39.7lb).

leg ends

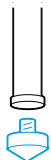

leg ends

All tripods and monopods in Series 1 and above are provided with removable rubber feet. This feature allows you to easily change worn out rubber feet or to fit other accessories, such as spiked feet or snow/sand shoes. (4 section tripods in Series 1 are excluded because the final leg section is too narrow to fit these ends).

spike feet



spike feet

This built-in accessory allows you to hang a stabilizing weight (e.g. a full camera bag or a sand/water bag) from the bottom of the tripod center column. Useful with long heavy lenses, on uneven ground or in windy conditions. The hook can hold up to 18kg (39.7lb).

head features

safe grip

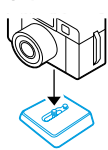

safe grip

Safe Grip is a material that gives a safer lock between your camera and the head plate, preventing the camera from moving or slipping. It is used on quick release plates and in applications where the camera equipment is screwed to the support to reduce pivoting and twisting.

separate pan control

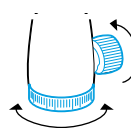

separate pan control

When using a ball head, the ability to lock and unlock the panoramic movement independent of front-back or lateral tilt movements is convenient for panoramic photography and when a high level of control is required.

friction control

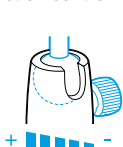

friction control

By fine tuning the freedom of movement of the head, friction control makes the head slower and more precise or faster and looser. This feature also helps to make using heavy equipment or long lenses safer. On ball and fluid head models without separate friction controls, slowly adjusting the lock knobs gives similar results.

balancing system

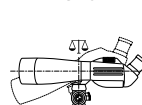

balancing system

In 1966 Gitzo was the first to introduce the balancing system. This system allows you to keep your equipment balanced when mounted on the head even when this is not locked. The system is very useful for long lenses, video and bird watching, especially when some degree of action and accurate tracking is needed.

double quick release safety system

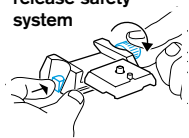

double quick release safety system

The system consists of two pins, one fixed and one manually operated by means of a button, that prevent camera equipment from suddenly dropping out of the head when the quick release locking knob is released. Extremely useful with heavy equipment, long lenses and spotting scopes.

reversible handles

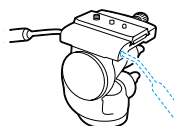

reversible handles

Handles can be removed and repositioned or rotated in different positions. This feature greatly increases a head's versatility and is particularly appreciated by left handed users.

fluid cartridge

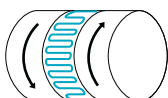

fluid cartridge

A fluid cartridge consists in a system made with two parts that slide one on the other. Inside the system is included a special fluid that controls the movement and makes it extremely soft, "fluid" and smooth. The cartridge's inner design is very important and if well designed allows maximum movement control yet minimizes cartridge weight and size. Gitzo uses a special fluid that guarantees a consistent performance over a wide range of temperatures.

tripod and head features

GITZO

tripod features

ground level set

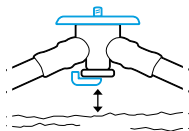

ground level set

This new feature allows you to remove the center column to save weight and get the camera closer to the ground. Uses existing components: the upper disc with reversible 1/4" - 3/8" bolt and the column hook assembly: remove column and fix the disk directly to the upper casting using the column hook. No tools needed.

G-Lock

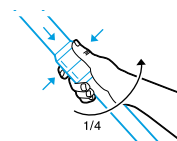

G-Lock

G-Lock is the new Gitzo leg locking system. The locking mechanism has been completely redesigned in order to achieve a 20% increase in rigidity, faster operation and stronger, safer locking. G-Lock's special design also provides a "gravity lock" effect: the higher the load applied vertically to the leg, the stronger the lock.

power disc

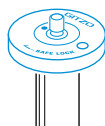

power disc

The new tripod upper disc is called "Power Disc". It is made of machined solid aluminum and it now features two locking screws, one to lock the head, the other to safely lock the disc onto the column. The "Power Disc" gives a rock solid connection of the whole system for additional safety and stability.

leg angles

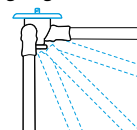

leg angles

Gitzo tripods feature a variety of leg openings. From one spread of series 0 to infinite angles of Explorer tripods. New series 1, 2, 3 and Leveling tripods now feature an upgraded upper casting with an additional third leg spread. The three leg spreads allows you to set the tripods at three different levels (high, medium, low). The new low position allows you to take full advantage of the "Ground Level Set".

ocean lock



ocean-lock

The Ocean-Lock is a special version of Gitzo G-Lock of which it maintains the same outstanding locking performances. Thanks to two special seals derived from the automation industry, it minimises the amount of water and debris that may enter tubes and locking mechanisms. The Ocean-Lock is not 100% waterproof, however it dramatically enhances the capacity of the tripod to withstand extreme environments.

head features

bubble ball

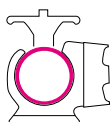

bubble ball

Gitzo has now developed a new exclusive technology that enables us to produce high quality, completely round hollow spheres, with a ultra thin wall, for an incredible weight reduction. Gitzo Bubble Ball also features a perfected PTFE treatment that further reduces the surface micro roughness for the ultimate shooting experience and accuracy.

leveling bubble

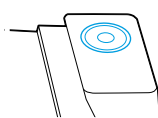

leveling bubble

The leveling bubble helps you to get your photographs, film or scope viewing perfectly horizontal or vertical. Gitzo's production staff set all levelling bubbles by hand in order to ensure 100% accurate level indication.

spring assisted double lock

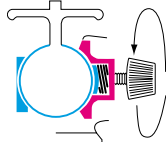

spring assisted double lock

The new center SADL (Spring Assisted Double Lock) is a patent pending system that combines two locking systems in one, that maximizes both locking power and ball smoothness. A high friction metal guarantees a high efficiency lock, the PTFE bushing controlled by a pre loaded spring maximizes smoothness and control.

single lock

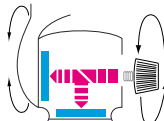

single lock

Single lock is the other specific innovation for bird watching. Pan and Tilt movements are locked and frictioned in parallel by a single large knob, making head control simple, fast and effective as never before.



This catalogue has been printed on paper from well-managed forests and other controlled sources.

www.gitzo.com

GITZO

focus on forever